

MURRAY RIVER
PADDLESTEAMERS

— PS EMMYLOU —
Authentic Australian River Cruises



ECHUCA VICTORIA AUSTRALIA
SEASON 2020/21

Luxury Boutique Australian River Cruising

Optional Melbourne Hotel Stay Begins Your Journey

Optional Melbourne Return Transfers

Multi-Course Dining Prepared
By Our Onboard Chefs

Riverside Dining & Campfires

Premium Onshore Guided Tours

Authentic Woodfired Paddlesteamer

Daily Historical Commentary

Complimentary Wifi Internet

Maximum 16 Guests Only



Contents

PS EMMYLOU STORY	2
CABINS	3
1 NIGHT MURRAY RIVER EXPERIENCE CRUISE	4
2 NIGHT MURRAY RIVER HIGHLIGHTS CRUISE	5
3 NIGHT MURRAY RIVER DISCOVER CRUISE	6
4 NIGHT MURRAY RIVER EXPLORER CRUISE	7
2 NIGHT TALO RETREAT & CRUISE PACKAGE	8
4 NIGHT TALO RETREAT & CRUISE PACKAGE	9
3 NIGHT BALGOWNIE WINERY RETREAT & CRUISE PACKAGE	10
4 NIGHT BALGOWNIE WINERY RETREAT & CRUISE PACKAGE	11
MELBOURNE HOTEL PARTNERS	12
2020-2021 CRUISE DEPARTURES	12
TERMS & CONDITIONS	13



PS EMMYLOU STORY

The side wheel paddlesteamers are distinctly Australian having first plied the Murray river in 1853, they established a thriving industry which survived until rail and roads began to service the region near the turn of the century. By 1873 there were 240 boats trading along the Murray River. The inland prospered as trade and commerce developed, and previously out of the way settlements were kept in touch with the cities.

With the introduction of the railway, the paddlesteamers and their industrious crews progressively lost work until the riverboat industry was but a shadow of it's illustrious past.

The Murray River which includes the Darling and Murrumbidgee rivers is one of the longest river systems in the world. Although weirs have cut down the navigability of the river, the Murray alone still claims 2508 kilometres of meandering waters.

PS Emmylou, the world's only wood-fired cruising paddlesteamer reminds us of the romantic days of the paddlesteamers and is now an Australian Icon of the River. Built locally during 1980-82 in the style of the 19th century paddlesteamers, she is perfectly at home at the Port of Echuca, residing with the last few remaining paddlesteamers of the past. She is 30 metres long and 10 metres wide, steel hulled and timber decked.

During 2018 PS Emmylou underwent a specially designed luxury upgrade and fit out. The new contemporary cabins and ensuites include fine linens topped with silky duvets, with the boats' premier cabin, the Emmylou Suite located on the front Upper Deck, with French Doors opening to a deck and 180 degree views of the river.

Guests can enjoy small boat boutique cruising at it's finest with just 16 guests comfortably accommodated in 8 deluxe cabins as PS Emmylou visits places of geographic, historic and Aboriginal cultural significance. Guests will also enjoy onshore tours visiting outstanding local wineries, dropping into local producers and accessing ancient world heritage Murray river tributaries aboard MV Kingfisher with an environmental specialist.

Onboard dining, prepared by the Emmylou's Chef, features local produce and wine from across the Heathcote and Perricoota wine regions. Riverside campfires are offered in the evenings, with stunning night skies to complete this unique experience.

We are proud to continue the tradition of overnight cruising on Australia's greatest waterway with our trademark level of country hospitality aboard an authentic paddlesteamer. We hope you can join us to connect you with Australia's inland history, geography, culture and cuisine.



CONNECT WITH US



@MURRAYRIVERPADDLESTEAMERS



@MURRAYRIVERPS



@MURRAYRIVERPS



MURRAYPADDLESTEAMERS

CABINS

DELUXE CABINS WITH PRIVATE ENSUITES

Welcome to your home aboard Paddlesteamer Emmylou. We invite you to relax in a warm inviting atmosphere of mid 1800's riverboat charm without sacrificing modern conveniences. Emmylou features contemporary deluxe cabins with fine linens and plush new bedding which will ensure you are well rested to fully enjoy your time aboard with us. Complimentary Wifi is available throughout the boat.

MAIN DECK

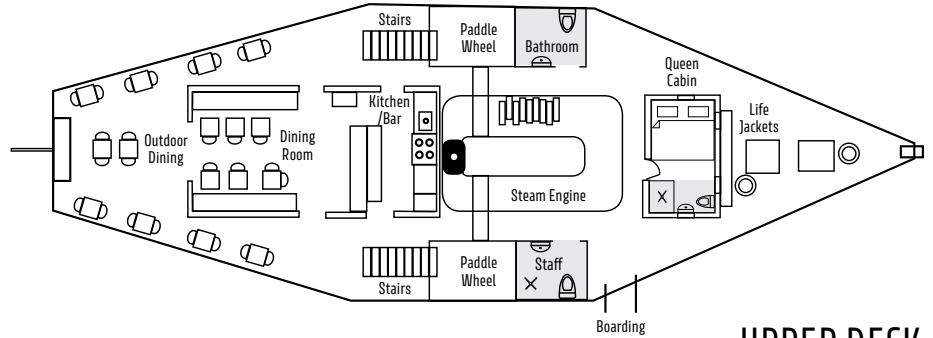

UPPER DECK

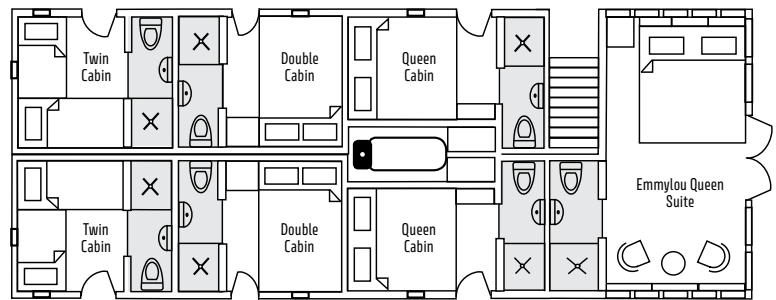

MAIN DECK CABIN

This private Queen Cabin boasts a plush queen bed and private ensuite. The cabin is conveniently situated on the Main Deck with close proximity to the dining Saloon.

UPPER DECK CABINS

Guests enjoying Upper Deck Cabins can choose from Queen, Double & Twin Single Cabins all with private ensuites, with doors opening to the outside affording neighbouring guests the unique opportunity to enjoy a social atmosphere, swapping stories and forming lasting friendships with fellow travellers.

EMMYLOU SUITE

The boats premier accommodation and most spacious. This elegant suite provides a warm ambiance located on the Upper Deck at the front of the boat with French Door opening to the deck. Featuring a seating area, ensuite and plush queen bedding guests can relax with a drink and watch the river banks of the Upper Murray drift by.



Twin Cabin



Double Cabin



Queen Cabin



Emmylou Queen Suite

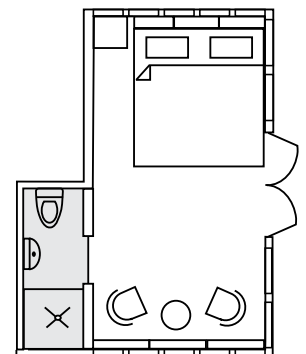
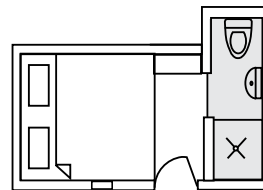
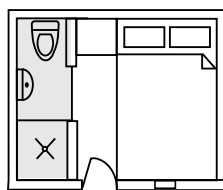
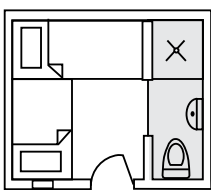

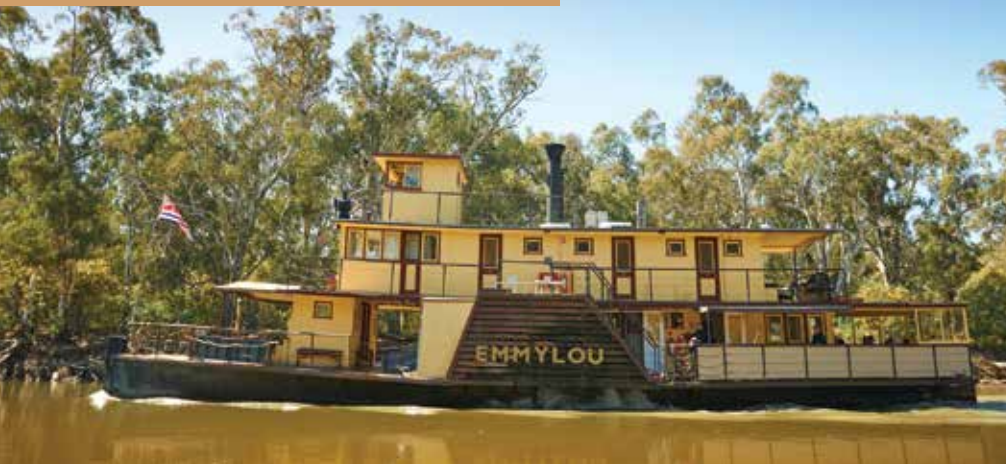

OPTIONAL EXTRAS

Melbourne Hotel Pre Stay & Return Transfers \$870 Per Couple
\$770 Solo Traveller

Melbourne Return Transfers \$620 Per Couple
\$520 Solo Traveller

Bendigo Return Transfers \$420 Per Couple
\$320 Solo Traveller

Self Drive Car Parking \$20 Per Night

SATURDAY DEPARTURES



1 NIGHT MURRAY RIVER EXPERIENCE CRUISE

Optional Ex Melbourne

Cruise departs Port of Echuca, Riverboat Dock, Echuca on Saturday at 6.30pm and returns to Echuca on Sunday morning at 9.30am.

FRIDAY – Optional Pre-Cruise Hotel Stay

Today you have time to explore the wonderful city of Melbourne before checking into your Pre Stay Hotel at Pan Pacific South Wharf. Take a free City tram ride, explore Flinders St Station, grab a coffee from one of the many laneway cafes, visit Eureka Sky Deck, National Galley of Victoria and lunch in Chinatown.

SATURDAY – Optional Transfers

Departing at 10.30am from your Hotel you travel to Echuca via Nagambie. Time to explore the many shops, pubs, cafes and historical Port of Echuca before your cruise departs at 6.30pm

After departing from the Port of Echuca you have time for a relaxing drink from the bar or a visit to the wheelhouse to see the Skipper as the sun starts to set over the river. Listen to the river birds evening chorus, watch for kangaroos, egrets and many other species of birds as the stars begin to appear while you enjoy your chef prepared dinner. PS Emmylou powerful floodlights then light the banks of the river as nocturnal wildlife begin to appear. After cruising upstream PS Emmylou turns to continue the

journey back downstream under the Echuca/Moama Bridge where we pass the imposing Echuca Wharf lit up for the evening and other Paddlesteamers moored after their day on the river.

Relax with a drink on the upper deck or just sit and let the river glide by before Emmylou pulls into her overnight mooring for the evening at Layfield Lane. Here we set up a campfire under the stars where you can enjoy a good yarn with your fellow passengers. Relax with a beverage from the bar or roast marshmallows before retiring for the evening at your leisure.

SUNDAY

Wake to an early morning bush walk or relax over breakfast as we cruise back to Echuca where we reluctantly say farewell arriving back at port at 9.30am. If you have chosen return transfers to Melbourne our coach takes you via the beautiful gold rush City of Bendigo. Here we pause for a coffee run at the trendy Chancery Lane, famous for their art, food and great coffee. The journey then continues to Melbourne for Melbourne Airport or CBD drop offs arriving at 2.30pm.

PRICES CRUISE ONLY

CABIN TYPE	PP TWIN SHARE	SOLO TRAVELER
Main Queen	\$430	\$645
Upper Twin	\$400	\$600
Upper Double	\$420	\$630
Upper Queen	\$430	\$645
Queen Suite	\$500	\$750

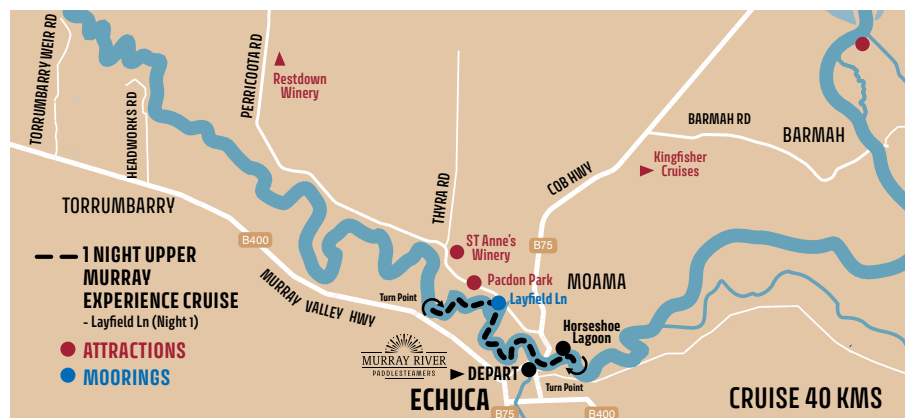



OPTIONAL EXTRAS

Melbourne Hotel Pre Stay & Return Transfers \$870 Per Couple
\$770 Solo Traveller

Melbourne Return Transfers \$620 Per Couple
\$520 Solo Traveller

Bendigo Return Transfers \$420 Per Couple
\$320 Solo Traveller

Self Drive Car Parking \$20 Per Night

THURSDAY DEPARTURES

2 NIGHT MURRAY RIVER HIGHLIGHTS CRUISE

- Optional Ex Melbourne

Cruise departs Port of Echuca, Riverboat Dock, Echuca on Thursday at 2.30pm and returns to Echuca on Saturday morning at 9.30am.

WEDNESDAY – Optional Pre-Cruise Hotel Stay

Today you have time to explore the wonderful city of Melbourne before checking into your Pre Stay Hotel at Pan Pacific South Wharf.

THURSDAY – Optional Transfers

Departing at 10.30am from your Hotel you travel to Echuca arriving at the historical Port of Echuca to board your cruise departing at 2.30pm.

Departing Echuca downriver, enjoy a welcome afternoon tea as you begin to relax and enjoy the sights and sounds of the river. Take the opportunity to chat Skipper in the wheelhouse about the rich history of the river and PS Emmylou. As the sun starts to set over the river, time for an evening cocktail before your chef prepared welcome dinner. Watch for kangaroos, wombats, egrets and many other species of birds as the stars begin to appear. Tonight, we moor at Layfield Lane where your welcome to join your fellow passenger around the roaring campfire to watch the stars appear in the stunning night sky before retiring for the evening.

FRIDAY

Wake to an early morning walk along the riverbank, home to native birds, plants and wildlife before enjoying breakfast. We then depart on a half day excursion travelling to the small town of Barmah for a guided Eco

Cruise, where you can get up close to Australian nature and wildlife gliding through the World-Heritage listed Barmah Wetlands aboard the MV Kingfisher.

We then enjoy a traditional Australian picnic lunch riverside before we continue to Pacdon Park, makers of fine UK small goods where you can sample their fine assortment of produce. We then visit the region's largest winery, St Anne's where you will enjoy a short winery tour provided by the owners and then taste their fabulous table and fortified wines. You will also have the opportunity to sample their delicious Echuca Cheeses and Chocolates all made from local produce.

It is then time to re-join PS Emmylou. Time to relax in the afternoon sun as Emmylou continues cruising up river past the imposing Echuca Wharf before turning bound for our overnight mooring at Horseshoe Lagoon. Tonight, after you have enjoyed your dinner, it's Movie Night, with a special presentation of "Riverboats Remembered" a fabulous historical presentation about the riverboats of the mid 1850's along the Murray River

SATURDAY

Time for an early morning walk on the boardwalk or relax over breakfast as we cruise back to Echuca where we reluctantly say farewell arriving at 9.30am. If you have chosen return transfers to Melbourne your coach will be ready for your return journey to Melbourne Airport or CBD drop offs arriving at 2.30pm.



PRICES CRUISE ONLY

CABIN TYPE	PP TWIN SHARE	SOLO TRAVELER
Main Queen	\$880	\$1,320
Upper Twin	\$830	\$1,245
Upper Double	\$860	\$1,290
Upper Queen	\$880	\$1,320
Queen Suite	\$1,020	\$1,530



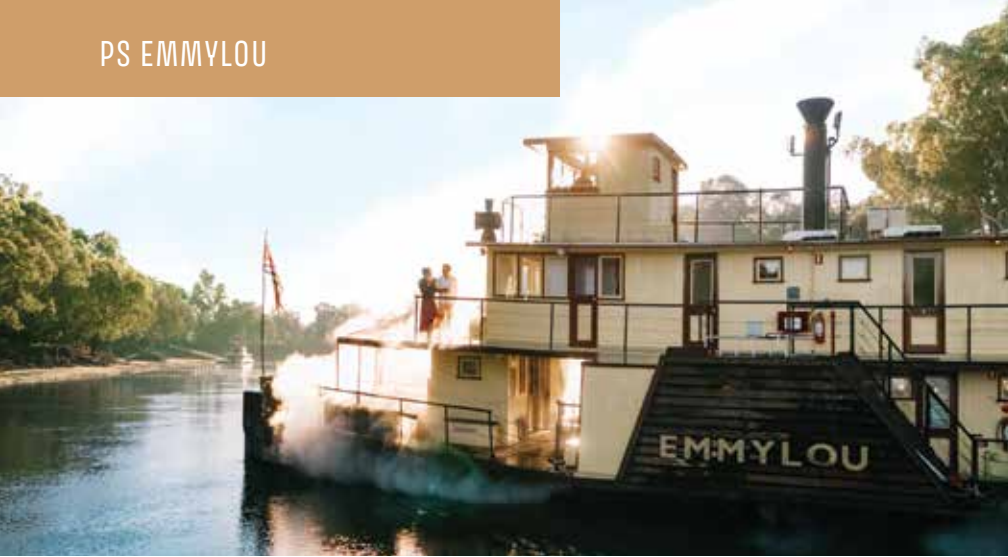

OPTIONAL EXTRAS

Melbourne Hotel Pre Stay & Return Transfers \$870 Per Couple
\$770 Solo Traveller

Melbourne Return Transfers \$620 Per Couple
\$520 Solo Traveller

Bendigo Return Transfers \$420 Per Couple
\$320 Solo Traveller

Self Drive Car Parking \$20 Per Night

THURSDAY DEPARTURES

3 NIGHT MURRAY RIVER DISCOVERY CRUISE

- Optional Ex Melbourne

Cruise departs Port of Echuca, Riverboat Dock, Echuca on Monday at 2.30pm and returns to Echuca on Thursday morning at 9.30am.

SUNDAY - Optional Pre-Cruise Hotel Stay

Today you have time to explore the wonderful city of Melbourne before checking into your Pre Stay Hotel at Pan Pacific South Wharf.

MONDAY - Optional Transfers

Departing at 10.30am from your Hotel you travel to Echuca arriving at the historical Port of Echuca to board your cruise departing at 2.30pm.

Departing Echuca downriver, enjoy a welcome afternoon tea as you begin to relax and enjoy the sights and sounds of the river. This evening as the sun begins to set over the river enjoy a cocktail before your welcome dinner. Watch for kangaroos, egrets and many other species of birds as the stars begin to appear. Tonight, we moor at the famous Perricoota Station. Rich in history, the property was first settled by James Maiden in 1843, and famous for starring in the TV movie "All the River Run" where PS Emmylou was renamed PS Philadelphia.

TUESDAY

Wake to an early morning self-guided walk of gardens scattered with old date palms before enjoying breakfast. We then depart on a half day excursion travelling to the small town of Barmah for a guided Eco Cruise, where you can get up close to Australian nature and wildlife gliding through the World-Heritage listed Barmah Wetlands aboard the MV Kingfisher.

Enjoy a picnic lunch riverside before we continue to the region's largest winery, St Anne's where you will enjoy a winery tour provided by the owners and taste their fabulous table and fortified wines, cheeses and chocolates.

It is then time to re-join PS Emmylou. For those that slept in you can join the Skipper for a guided tour of the gardens and buildings before Emmylou continues upriver towards Deep Creek Marina. Tonight, after dinner, it's Movie Night, with a special presentation of "Riverboats Remembered" a fabulous historical presentation about the riverboats of the mid 1850's along the Murray River.

WEDNESDAY

This morning PS Emmylou departs on a full day of cruising towards our Layfield Lane mooring. Today your welcome to try your hand at steering the boat with the Skipper. Tonight, you will enjoy our signature Grand Dining gourmet Australian BBQ. Enjoy sampling the delicious range of Pacdon Park UK small goods for entrée before enjoying dinner under the stars. After dinner enjoy some yarns sitting around the campfire before retiring for the evening.

THURSDAY

Time for an early morning walk along the riverbank or relax over breakfast as we cruise back to Echuca where we reluctantly say farewell arriving at 9.30am. If you have chosen return transfers to Melbourne your coach will be ready for your return journey to Melbourne Airport or CBD drop offs arriving at 2.30pm.



PRICES CRUISE ONLY

CABIN TYPE	PP TWIN SHARE	SOLO TRAVELER
Main Queen	\$1,440	\$2,160
Upper Twin	\$1,350	\$2,025
Upper Double	\$1,400	\$2,100
Upper Queen	\$1,440	\$2,160
Queen Suite	\$1,600	\$2,400

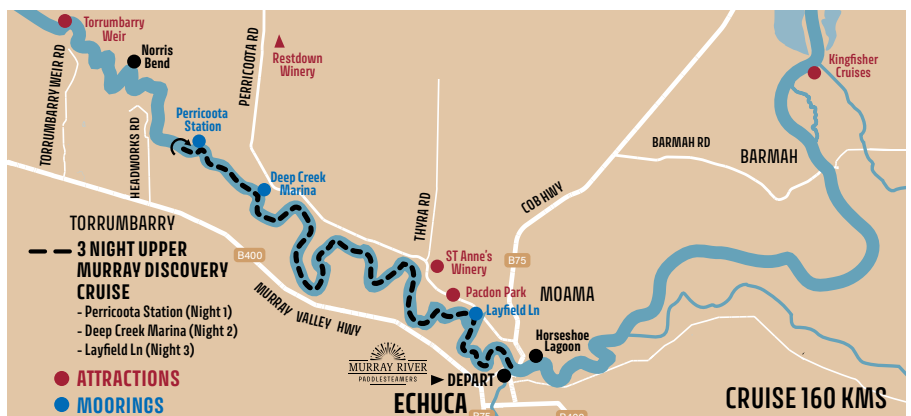



OPTIONAL EXTRAS

Melbourne Hotel Pre Stay & Return Transfers	\$870 Per Couple \$770 Solo Traveller
---	--

Melbourne Return Transfers	\$620 Per Couple \$520 Solo Traveller
-------------------------------	--

Bendigo Return Transfers	\$420 Per Couple \$320 Solo Traveller
-----------------------------	--

Self Drive Car Parking	\$20 Per Night
------------------------	----------------

THURSDAY DEPARTURES



PRICES CRUISE ONLY

CABIN TYPE	PP TWIN SHARE	SOLO TRAVELER
Main Queen	\$2,000	\$3,000
Upper Twin	\$1,865	\$2,798
Upper Double	\$1,940	\$2,910
Upper Queen	\$2,000	\$3,000
Queen Suite	\$2,200	\$3,300

4 NIGHT MURRAY RIVER EXPLORER CRUISE

- Optional Ex Melbourne

Cruise departs Port of Echuca, Riverboat Dock, Echuca on Monday at 2.30pm and returns to Echuca on Thursday morning at 9.30am.

SUNDAY – Optional Pre-Cruise Hotel Stay

Today you have time to explore the wonderful city of Melbourne before checking into your Pre Stay Hotel at Pan Pacific South Wharf.

MONDAY – Optional Transfers

Departing at 10.30am from your Hotel you travel to Echuca arriving at the historical Port of Echuca to board your cruise departing at 2.30pm.

Departing Echuca downriver, enjoy afternoon tea as you begin to relax and enjoy the sights and sounds of the river. This evening enjoy a welcome dinner and watch for kangaroos, egrets and many other species of birds as the stars begin to appear. Tonight, we moor at the famous Perricoota Station. Rich in history, the property was first settled by James Maiden in 1843.

TUESDAY

This morning we depart for Restdown Winery where you will enjoy a guided wetlands walk of early Aboriginal significance followed by a gourmet lunch with complementary wine tastings. We then visit Arbutnot Redgum Sawmill dating back to 1889 for a short tour of the redgum mill before arriving at Torrumbarry Weir where you can learn about the Weir and lock system. This afternoon we cruise towards our overnight bush mooring at Norris Bend. After dinner it is movie night, with a special presentation of "Riverboats Remembered" a fabulous historical presentation about the riverboats of the mid 1850's.

WEDNESDAY

This morning Emmylou steams towards Perricoota Station where you can join the Skipper for a guided walking tour of the gardens before we depart to the small town of Barmah. Enjoy a picnic lunch riverside before departing on your guided Eco Cruise, where you can get up close to Australian nature and wildlife gliding through the World-Heritage listed Barmah Wetlands aboard the MV Kingfisher. It is then time to re-join PS Emmylou as we continue cruising upriver towards our overnight mooring at Deep Creek Marina.

THURSDAY

This morning we depart for a full days cruising towards our Layfield Lane mooring. Enjoy breakfast on the deck then relax with a good book or just take in the river views and wildlife. Tonight, you will enjoy our signature Grand Dining gourmet Australian BBQ. Enjoy sampling the delicious range of Pacdon Park UK small goods for entrée before enjoying dinner under the stars followed by some yarns sitting around the campfire before retiring for the evening.

FRIDAY

Enjoy an early morning walk along the riverbank before breakfast as we cruise back to Echuca where we reluctantly say farewell arriving at 9.30am. If you have chosen return transfers to Melbourne your coach will be ready for your return journey to Melbourne Airport or CBD drop offs arriving at 2.30pm.

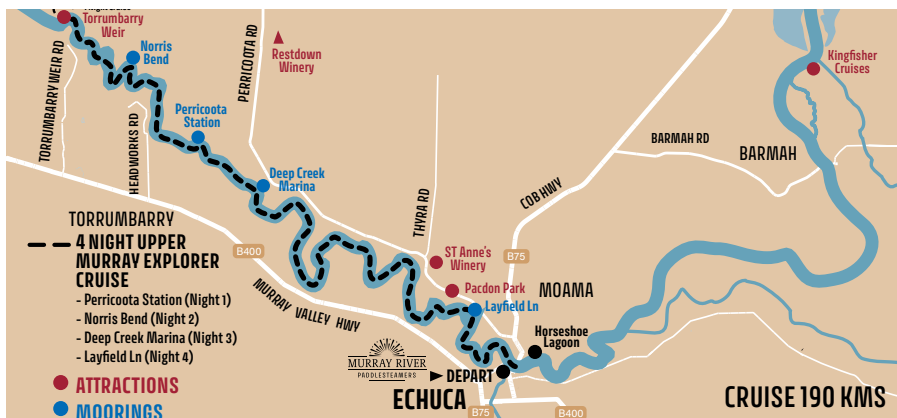



OPTIONAL EXTRAS

Melbourne Hotel Pre Stay & Return Transfers \$870 Per Couple
\$770 Solo Traveller

Melbourne Return Transfers \$620 Per Couple
\$520 Solo Traveller

Bendigo Return Transfers \$420 Per Couple
\$320 Solo Traveller

Self Drive Car Parking \$20 Per Night

SATURDAY CRUISE DEPARTURE



2 NIGHT TALO RETREAT & CRUISE PACKAGE

- Optional Ex Melbourne

Friday night Stay at Talo Retreat. Cruise departs Port of Echuca, Riverboat Dock, Echuca on Saturday at 6.30pm and returns Sunday at 9.30am.

THURSDAY – Optional Pre-Cruise Hotel Stay

Today you have time to explore the wonderful city of Melbourne before checking into your Pre Stay Hotel at Pan Pacific South Wharf.

FRIDAY – Optional Transfers

Departing at 10.30am from your Hotel you travel to Echuca via Nagambie arriving at Talo Retreat. Checking in from 2.00pm spend the afternoon exploring Talo Retreat experiencing the wonders of the Murray river from the riverbanks. Relax in the tranquility of this natural bush setting staying in your own private deluxe Yurt. Enjoy the magical star gazing from your outdoor spa. Situated only 100m from the river enjoy relaxing around a camp fire or explore the area by canoe or bike.

SATURDAY

Spend the day exploring the historic Port of Echuca, shop in High Street, grab a coffee from one of the many café's or relax over lunch at a local Pub.

After departing from the Port of Echuca you have time for a relaxing drink from the bar or a visit to the wheelhouse to see the Skipper as the sun starts to set over the river. Listen to the

river birds evening chorus, watch for kangaroos, egrets and many other species of birds as the stars begin to appear while you enjoy your chef prepared dinner. PS Emmylou powerful floodlights then light the banks of the river as nocturnal wildlife begin to appear. After cruising upstream PS Emmylou turns to continue the journey back downstream under the Echuca/Moama Bridge where we pass the imposing Echuca Wharf lit up for the evening and other Paddlesteamers moored after their day on the river.

Relax with a drink on the upper deck or just sit and let the river glide by before Emmylou pulls into her overnight mooring for the evening at Layfield Lane. Here we set up a campfire under the stars where you can enjoy a good yarn with your fellow passengers. Relax with a beverage from the bar or roast marshmallows before retiring for the evening at your leisure.

SUNDAY

Wake to an early morning bush walk or relax over breakfast as we cruise back to Echuca where we reluctantly say farewell arriving back at port at 9.30am. If you have chosen return transfers to Melbourne your coach will be ready for your return journey to Melbourne Airport or CBD drop offs arriving at 2.30pm.

PRICES

CABIN TYPE	PP TWIN SHARE	SOLO TRAVELER
Main Queen	\$530	\$795
Upper Twin	\$500	\$750
Upper Double	\$520	\$780
Upper Queen	\$530	\$795
Queen Suite	\$600	\$900

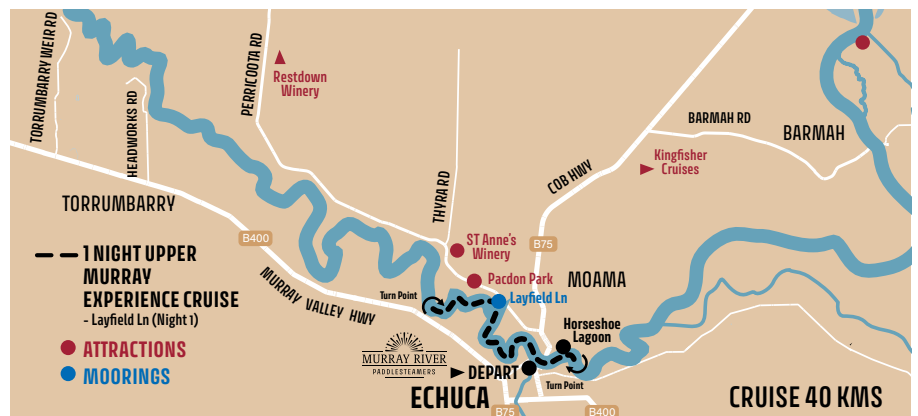



OPTIONAL EXTRAS

Melbourne Hotel Pre Stay & Return Transfers \$870 Per Couple
\$770 Solo Traveller

Melbourne Return Transfers \$620 Per Couple
\$520 Solo Traveller

Bendigo Return Transfers \$420 Per Couple
\$320 Solo Traveller

Self Drive Car Parking \$20 Per Night

THURSDAY CRUISE DEPARTURE



4 NIGHT TALO RETREAT & CRUISE PACKAGE

- Optional Ex Melbourne

Stay Tuesday/Wednesday at Talo Retreat. Cruise departs Port of Echuca, Riverboat Dock, Echuca on Thursday at 2.30pm and returns Saturday at 9.30am.

MONDAY – Optional Pre-Cruise Hotel Stay
Today you have time to explore the wonderful city of Melbourne before checking into your Pre Stay Hotel at Pan Pacific South Wharf.

TUESDAY – Optional Transfers
Departing at 10.30am from your Hotel you travel to Echuca arriving at Talo Retreat. Checking in from 2.00pm spend the afternoon exploring Talo Retreat experiencing the wonders of the Murray river from the riverbanks. Relax in the tranquility of this natural bush setting staying in your own private deluxe Yurt.

WEDNESDAY
Free day to explore the Perricoota wine district or just relax in your nature all bush setting.

THURSDAY
Departing Echuca downriver, enjoy a welcome afternoon tea as you begin to relax and enjoy the sights and sounds of the river. Take the opportunity to chat Skipper in the wheelhouse about the rich history of the river and PS Emmylou. As the sun starts to set over the river, time for an evening cocktail before your chef prepared welcome dinner. Watch for kangaroos, wombats, egrets and many other species of birds as the stars begin to appear. Tonight, we moor at Layfield Lane where your welcome to join your fellow passenger around the roaring campfire to watch the stars appear

in the stunning night sky before retiring for the evening.

FRIDAY
This morning we depart on a half day excursion travelling to the small town of Barmah for a guided Eco Cruise, where you can get up close to Australian nature and wildlife gliding through the World-Heritage listed Barmah Wetlands aboard the MV Kingfisher followed by a picnic lunch riverside. We then continue to Pacdon Park, makers of fine UK small where you can sample their fine assortment of produce followed by a visit to St Anne's Winery where you will enjoy a winery tour provided by the owners and then taste their fabulous table and fortified wines, cheeses and chocolates.

It is then time to re-join PS Emmylou. Time to relax in the afternoon sun as Emmylou continues cruising upriver past the imposing Echuca Wharf before turning bound for our overnight mooring at Horseshoe Lagoon. Tonight, after you have enjoyed your dinner, it's Movie Night, with a special presentation of "Riverboats Remembered" a fabulous historical presentation about the riverboats of the mid 1850's along the Murray River.

SATURDAY
Time for an early morning walk on the boardwalk or relax over breakfast as we cruise back to Echuca where we reluctantly say farewell arriving at 9.30am. If you have chosen return transfers to Melbourne your coach will be ready for your return journey to Melbourne Airport or CBD drop offs arriving at 2.30pm.

PRICES

CABIN TYPE	PP TWIN SHARE	SOLO TRAVELER
Main Queen	\$1,080	\$1,620
Upper Twin	\$1,020	\$1,530
Upper Double	\$1,060	\$1,590
Upper Queen	\$1,080	\$1,620
Queen Suite	\$1,220	\$1,830

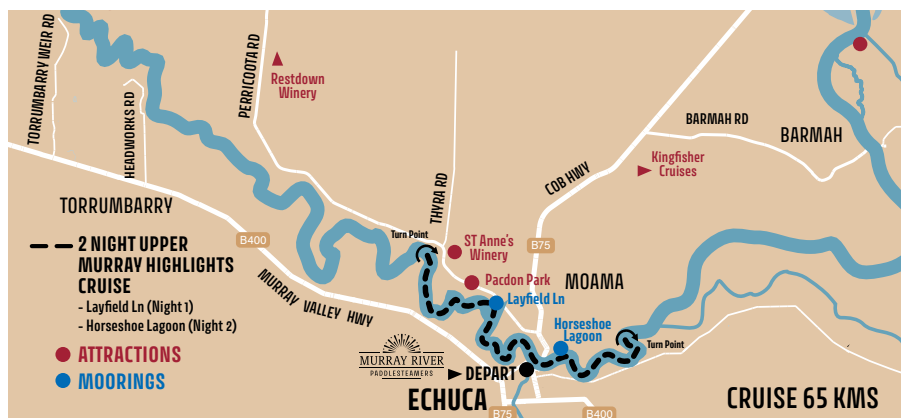



OPTIONAL EXTRAS

Melbourne Hotel Pre Stay & Return Transfers \$950 Per Couple
\$850 Solo Traveller

Melbourne Return Transfers \$700 Per Couple
\$600 Solo Traveller

Bendigo Return Transfers \$420 Per Couple
\$320 Solo Traveller

Self Drive Car Parking \$20 Per Night

SATURDAY CRUISE DEPARTURE



3 NIGHT BALGOWNIE WINERY RETREAT & CRUISE PACKAGE

- Optional Ex Melbourne, Bendigo

Stay Thursday/Friday at Balgownie Winery Estate. One night Emmylou Cruise departs Port of Echuca, Riverboat Dock, Echuca on Saturday 6.30pm and returns Sunday at 9.30am.

THURSDAY - Optional Transfers

Arriving from Melbourne or Bendigo Airport, sits Balgownie Estate Winery, Retreat & Restaurant. Hidden away amongst the vineyards sits your luxe Safari tent. Enjoy all the modern conveniences you would expect including a Ensuite, Queen Bed and a private deck with outdoor bath overlooking the uninterrupted views of the vines and nature.

FRIDAY

Today spend the day relaxing in your winery bush setting or explore the City of Bendigo famous for its Art, Culture and exhibitions. Jump on a Talking Tram, visit the Deborah Gold Mine and enjoy lunch at a Chancery Lane café, famous for great coffee and food.

SATURDAY - Optional Transfers

Departing at 10.30am from Balgownie Estate your travel to Echuca. Enjoy the day exploring the many shops, pubs, cafés and historical Port of Echuca before your cruise departs at 6.30pm. After departing from the Port of Echuca you have time for a relaxing drink from the bar or a visit to the wheelhouse to see the Skipper as the sun starts to set over the river. Listen to the river birds evening chorus, watch for kangaroos,

egrets and many other species of birds as the stars begin to appear while you enjoy your chef prepared dinner. PS Emmylou powerful floodlights then light the banks of the river as nocturnal wildlife begin to appear. After cruising upstream PS Emmylou turns to continue the journey back downstream under the Echuca/Moama Bridge where we pass the imposing Echuca Wharf lit up for the evening and other Paddlesteamers moored after their day on the river.

Relax with a drink on the upper deck or just sit and let the river glide by before Emmylou pulls into her overnight mooring for the evening at Layfield Lane. Here we set up a campfire under the stars where you can enjoy a good yarn with your fellow passengers. Relax with a beverage from the bar or roast marshmallows before retiring for the evening at your leisure.

SUNDAY

Wake to an early morning bush walk or relax over breakfast as we cruise back to Echuca where we reluctantly say farewell arriving back at port at 9.30am. If you have chosen return transfers to Melbourne or Bendigo our coach takes via Bendigo's trendy Chancery Lane, famous for their art, food and great coffee. The journey then continues to Melbourne for Melbourne Airport or CBD drop offs arriving at 2.30pm.

PRICES

CABIN TYPE	PP TWIN SHARE	SOLO TRAVELER
Main Queen	\$730	\$1,095
Upper Twin	\$650	\$975
Upper Double	\$720	\$1,080
Upper Queen	\$730	\$1,095
Queen Suite	\$780	\$1,170

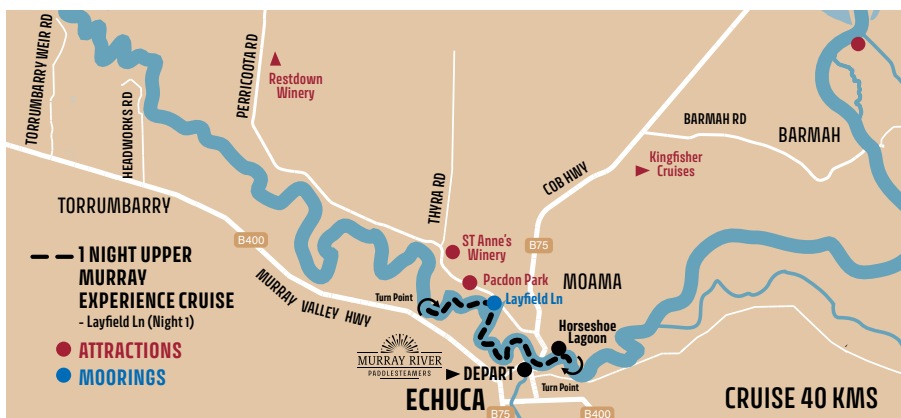

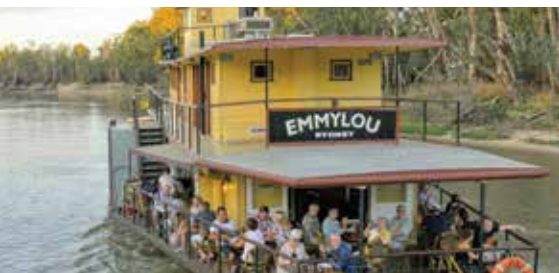

OPTIONAL EXTRAS

Melbourne Hotel Pre Stay & Return Transfers \$950 Per Couple
\$850 Solo Traveller

Melbourne Return Transfers \$700 Per Couple
\$600 Solo Traveller

Bendigo Return Transfers \$420 Per Couple
\$320 Solo Traveller

Self Drive Car Parking \$20 Per Night

THURSDAY CRUISE DEPARTURE



4 NIGHT BALGOWNIE WINERY RETREAT & CRUISE PACKAGE

- Optional Ex Melbourne, Bendigo

Stay Tuesday/Wednesday at Balgownie Winery Retreat. Two Night Emmylou Cruise departs Port of Echuca, Riverboat Dock, Echuca on Thursday at 6pm and returns Saturday at 9.30am.

TUESDAY - Optional Transfers

Arriving from Melbourne or Bendigo Airport, sits Balgownie Estate Winery, Retreat & Restaurant. Hidden away amongst the vineyards sits your luxe Safari tent. Enjoy an Ensuite, Queen Bed and a private deck with outdoor bath overlooking the uninterrupted views of the vines and nature.

WEDNESDAY

Today spend the day relaxing in your winery bush setting or explore the City of Bendigo.

THURSDAY

Departing Echuca downriver, enjoy a welcome afternoon tea as you begin to relax and enjoy the sights and sounds of the river. Take the opportunity to chat Skipper in the wheelhouse about the rich history of the river and PS Emmylou. As the sun starts to set over the river, time for an evening cocktail before your chef prepared welcome dinner. Watch for kangaroos, wombats, egrets and many other species of birds as the stars begin to appear. Tonight, we moor at Layfield Lane where your welcome to join your fellow passenger around the roaring campfire to watch the stars appear in the stunning night sky before retiring for the evening.

FRIDAY

This morning we depart on a half day excursion travelling to the small town of Barmah for a guided Eco Cruise, where you can get up close to Australian nature and wildlife gliding through the World-Heritage listed Barmah Wetlands aboard the MV Kingfisher followed by a picnic lunch riverside. We then continue to Pacdon Park, makers of fine UK small where you can sample their fine assortment of produce followed by a visit to St Anne's Winery where you will enjoy a winery tour provided by the owners and then taste their fabulous table and fortified wines, cheeses and chocolates.

It is then time to re-join PS Emmylou. Time to relax in the afternoon sun as Emmylou continues cruising upriver past the imposing Echuca Wharf before turning bound for our overnight mooring at Horseshoe Lagoon. Tonight, after you have enjoyed your dinner, it's Movie Night, with a special presentation of "Riverboats Remembered" a fabulous historical presentation about the riverboats of the mid 1850's along the Murray River.

SATURDAY

Time for an early morning walk on the boardwalk or relax over breakfast as we cruise back to Echuca where we reluctantly say farewell arriving at 9.30am. If you have chosen return transfers to Melbourne your coach will be ready for your return journey to Melbourne Airport or CBD drop offs arriving at 2.30pm.

PRICES

CABIN TYPE	PP TWIN SHARE	SOLO TRAVELER
Main Queen	\$1,095	\$1,643
Upper Twin	\$1,020	\$1,530
Upper Double	\$1,065	\$1,598
Upper Queen	\$1,095	\$1,643
Queen Suite	\$1,175	\$1,763

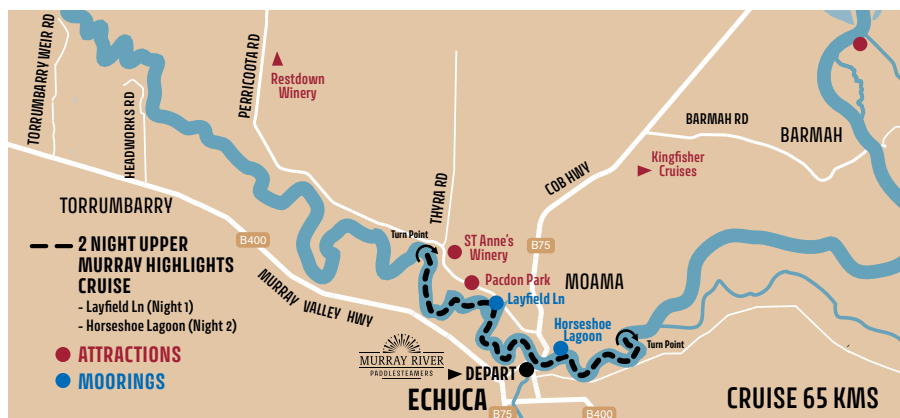

MELBOURNE HOTEL PARTNERS

We are delighted to be partnering with the Pan Pacific Group with over 40 Hotels across Oceania, Asia & North America.



PAN PACIFIC SOUTH WHARF

Discover city of Melbourne along the Yarra River. Enjoy waterfront living at Pan Pacific Melbourne as you explore the South Wharf precinct with fabulous outlet shopping and bustling Melbourne just across the river.



PARKROYAL MELBOURNE AIRPORT

Why rush when your hotel is located so close to the airport. Arrive in style at Parkroyal Melbourne Airport. With direct access to international and domestic terminals you will enjoy convenience like no other.

\$80 per night surcharge applies for weekday stays at Parkroyal Hotel, Melbourne Airport.



2020-2021 CRUISE DEPARTURES

CRUISE DATES MAY BE SUBJECT TO CHANGE. SUBJECT TO AVAILABILITY

APRIL 2020

M	T	W	T	F	S	S
		1	2	3	4	5
6	7	8	9	10	11	12
13	14	15	16	17	18	19
20	21	22	23	24	25	26
27	28	29	30			

MAY 2020

M	T	W	T	F	S	S
				1	2	3
4	5	6	7	8	9	10
11	12	13	14	15	16	17
18	19	20	21	22	23	24
25	26	27	28	29	30	31

JUNE 2020

M	T	W	T	F	S	S
1	2	3	4	5	6	7
8	9	10	11	12	13	14
15	16	17	18	19	20	21
22	23	24	25	26	27	28
29	30					

JULY 2020

M	T	W	T	F	S	S
		1	2	3	4	5
6	7	8	9	10	11	12
13	14	15	16	17	18	19
20	21	22	23	24	25	26
27	28	29	30	31		

AUGUST 2020

M	T	W	T	F	S	S
31					1	2
3	4	5	6	7	8	9
10	11	12	13	14	15	16
17	18	19	20	21	22	23
24	25	26	27	28	29	30

SEPTEMBER 2020

M	T	W	T	F	S	S
	1	2	3	4	5	6
7	8	9	10	11	12	13
14	15	16	17	18	19	20
21	22	23	24	25	26	27
28	29	30				

OCTOBER 2020

M	T	W	T	F	S	S
			1	2	3	4
5	6	7	8	9	10	11
12	13	14	15	16	17	18
19	20	21	22	23	24	25
26	27	28	29	30	31	

NOVEMBER 2020

M	T	W	T	F	S	S
30						1
2	3	4	5	6	7	8
9	10	11	12	13	14	15
16	17	18	19	20	21	22
23	24	25	26	27	28	29

DECEMBER 2020

M	T	W	T	F	S	S
	1	2	3	4	5	6
7	8	9	10	11	12	13
14	15	16	17	18	19	20
21	22	23	24	25	26	27
28	29	30	31			

JANUARY 2021

M	T	W	T	F	S	S
				1	2	3
4	5	6	7	8	9	10
11	12	13	14	15	16	17
18	19	20	21	22	23	24
25	26	27	28	29	30	

FEBRUARY 2021

M	T	W	T	F	S	S
1	2	3	4	5	6	7
8	9	10	11	12	13	14
15	16	17	18	19	20	21
22	23	24	25	26	27	28

MARCH 2021

M	T	W	T	F	S	S
1	2	3	4	5	6	7
8	9	10	11	12	13	14
15	16	17	18	19	20	21
22	23	24	25	26	27	28
29	30	31				

1 NIGHT MURRAY RIVER EXPERIENCE
 2 NIGHT MURRAY RIVER HIGHLIGHTS
 3 NIGHT MURRAY RIVER DISCOVERY
 4 NIGHT MURRAY RIVER EXPLORER

TERMS & CONDITIONS

General

The transportation of guests and baggage aboard the vessel/s is governed by these Terms and Conditions. Please carefully read the terms of this cruise agreement.

Your payment of deposit or full fare constitutes agreement to these terms and conditions which includes limitations and exonerations of the liabilities and obligations of Carrier. You should read and understand these terms and conditions carefully before making a deposit. The vessel/s is operated by Australian Paddlesteamers Pty Ltd, trading as Murray River Paddlesteamers (MRPS) and is regularly inspected by the Australian Maritime Safety Authority, AMSA.

Definitions

The terms "you" and "Guests" refer to any and all person(s) named on the front of the Confirmation and include all children or others under the care or control of the named person(s). The term "Carrier" includes Murray River Paddlesteamers, its parent and affiliated entities, the vessels, the owners, charterers, operators, agents, and masters and crews thereof, any substituted or connecting ship, the owners, charterers and operators and all launches belonging to any such boat or owned or operated by the owners, charterers or operators. The term "Fare" includes voyage and shore excursions purchased from Carrier.

Fares are in Australian Dollars, are per guest, are based on double occupancy, and do not include air or land transport.

Single Occupancy Fares carry a 50% surcharge. Port charges are included in the fare. All fares, itineraries, themes, entertainment, shore excursions and other voyage attributes are subject to change without notice and we reserve the right to not honour any published prices that we determine were erroneous due to printing, electronic or clerical error.

Deposit and Final Payment

For confirmation of individual bookings, a deposit of 30% of the full fare per person is due upon booking online & within 3 days if booking direct or via a travel agent. The balance of the voyage fare is due 60 days (60) prior to departure date, and all reservations not fully paid at such time will be cancelled and subject to the cancellation provisions set forth in the cancellation policy below. MRPS accepts the following forms of payment: MasterCard, Visa & Bank Transfer. A credit card surcharge between 1.20% - 1.70% maybe incurred for credit card payments depending on the credit card used. Domestic Australian Bank Transfers incur no surcharge or cost. International Bank Transfers incur a minimum A\$15 fee which must be added to the payment made. Bookings made sixty (60) days or less prior to the departure date require payment in full at the time of booking.

Cancellation and Change Policy

Guests who must cancel or change the date of their voyage or any part of their package for any reason, including medical or family reasons, are subject to the fees as outlined below. All fares are based on double occupancy, on reservations in which one guest cancels, the remaining guest is responsible for paying any and all single supplements. MRPS reserves the right to cancel all reservations for which final payment is not received sixty (60) days prior to the departure date. For cancellations made greater than 31 days from departure, transfer to another similar cruise is allowed within 12 months of booking date. Any price difference must be paid.

Days Prior to Departure

Up to 91 days	\$350 Fee Per Booking
90-61 days	Loss of deposit
60-31 days	50% of gross fare
30-0 days	100% of gross fare

MRPS recommends that all guests obtain travel insurance for unforeseen circumstances.

Included in your fare

- Bottled water
- Coffee & Tea
- Wi-Fi Internet access aboard the vessel
- Gratuities to vessel crew
- All meals
- All standard shore excursions

Not included in your fare

- Airfare to and from your home city
- Alcoholic beverages
- Travel Insurance
- Transfers to and from Melbourne

Payment for additional goods and services must be made prior to the guest's disembarkation.

Documentation

Final travel reminder, including itinerary and passenger cruise information guide will be sent two (2) weeks prior to departure. Itineraries are subject to change without notice.

Health & Disability Requirements

Guests must notify MRPS in writing at the time of booking of any physical or mental illness, disability or other conditions for which special accommodations or the use of a wheelchair is necessary or contemplated. Also, we must be notified of any medical treatment that may render the guest unfit for travel or constitute a risk or danger to the guest or anyone else aboard. The vessel does not carry a medical doctor aboard. Acute medical conditions will require you to disembark to be attended to by shore-side emergency and/or medical response. Guests needing any form of assistance and those who are physically disabled must be accompanied by someone who will take full responsibility for any needed assistance during the cruise and in the event of an emergency. We reserve the right to refuse passage to anyone who, in our sole opinion, may affect the health, safety or enjoyment of other guests. Guests requiring a wheelchair must provide their own collapsible wheelchair. Please be aware that some ports of call, shore excursions, docks, gangways and other requirements may preclude a wheelchair guest from leaving the vessel; this decision will be made by the ship's captain and is binding. Also, there may be certain physical conditions, including stairways and narrow passageways within the vessel that may limit or preclude the accessibility of wheelchair guests to some areas. We strongly recommend you purchase travel insurance. With travel insurance, you can plan and enjoy your trip with complete peace of mind.

Smoking

Smoking is not permitted anywhere aboard the vessel including inside cabins and suites.

Dining Arrangements

MRPS offer open-seating for breakfast, lunch and dinner. To make a seating request with other guests aboard please contact us.

Gambling

Gambling is not permitted on the Vessel/s.

Animals

Only designated service animals are permitted aboard. You are required to notify MRPS in advance of departure if you plan to bring along a service animal because of a disability. Supporting documents may be requested.

Carrier's Discretion

As the Carrier, we reserve the right at any time, without notice, to cancel any cruise or Cruise Tour, to change or postpone the date or time of sailing or arrival, to change the port of embarkation or final destination, to shorten the cruise or to change or substitute any component of the Cruise Tour. If we are required to do any of these things, we will be responsible to you as follows:

If we cancel the cruise or Cruise Tour before it has started, we will refund the Cruise Fare that we have actually received. If the scheduled sailing date or time is delayed and as a result of that delay, you are not otherwise accommodated on board the Ship, we may arrange hotel accommodations and food at no additional expense to you for the duration of the delay. If the cruise is shortened, we will make a proportionate refund of the

Cruise Fare. MRP responsibility does not extend beyond the vessel, and whenever passengers leave it, any arrangements made by them or for them are at their own risk.

Limitation on Carrier's Liability

(a) No liability for certain events. The Carrier and the vessel/s shall not be liable for loss, death, or delay of, or injury to, any passenger or loss or damage or delay to his/her baggage, personal effects or other property, arising from: acts of God, public enemy, government restraint, riots, strikes, lockouts, labour troubles, whoever may be the instigators thereof, epidemic, civil disturbances of whatever nature, perils of the rivers, or other navigable waters, fuel shortages, collision, stranding, fire, theft, barratry, or any other crime by any person, faults or errors of navigation or management of this or any other vessel, explosions, breakage of shafts or any defect or unseaworthiness in hull, machinery or appurtenances, equipment, furnishings or supplies of the vessel or launches or vehicles or any defect of the Carrier's premises, at whatever time existing, fault or neglect of pilots, tugs, regular members of the crew, agents, servants, independent contractors.

(b) Limitation on Carrier's liability with respect to baggage and personal property. This liability shall not exceed one hundred Australian Dollars in the event of loss, damage or delay to any of the passenger's baggage or other property taken with him/her on the voyage.

Guest Warranties.

You warrant that you and all other Guests traveling with you are physically, emotionally and otherwise fit to undertake the cruise or Cruise Tour; that you and they have received all medical inoculations necessary; that you and they will at all times comply with the Ship's rules and regulations and orders and directions of the Ship's Captain and officers, and that your conduct will not impair the safety of the Ship or jeopardize or inconvenience other Guests. We may disembark at any time any Guest who may be suffering from contagious or infectious diseases or whose presence, in the opinion of the Captain, may be detrimental to the comfort or safety of other Guests or the crew. In such cases, the Guest shall not be entitled to any refund of the cruise fare or Cruise Tour fare or any compensation whatsoever.

Alcohol Policy

The sale and consumption of alcoholic beverages will be limited to Guests who are 18 years or older. MRPS promotes the responsible service of alcohol and will refuse service to guests if deemed to be intoxicated. Guests are kindly reminded to consume alcohol in moderation. MRPS reserves the right to prohibit and retain all liquor brought onto vessels which is strictly prohibited.

Use of Likeness

Carrier has the exclusive right to use video and other visual/ audio portrayals of you or your likeness taken during your cruise in any medium of any nature whatsoever for any purpose, including advertising or promoting the services of Carrier without any compensation being paid to You. Any such portrayal or likeness shall be the exclusive property of the Carrier.

Children

MRPS requires that children under the age of 18 be accompanied by a parent or other responsible adult 25 years or older. Children under 15 are not encouraged and must occupy their own cabin, no sharing with Parents is permitted. Children are required to pay full fare. Number of children will be limited.

Non-Transferrable Tickets

- (a) Your authority to agree. In buying the passenger ticket you state that you are authorised by or on behalf of any passenger listed on the ticket (including any minor) to agree to all the terms and conditions of this agreement.
- (b) No transfer. This agreement is between the Carrier and the passenger. It cannot be sold, assigned or transferred to any other person without prior express written consent of the Carrier.

Terms and conditions are subject to change without notice and we are not responsible for errors or omissions therein.





MURRAY RIVER

PADDLESTEAMERS

Authentic Australian River Cruises

MURRAY RIVER PADDLESTEAMERS

57 MURRAY ESPLANADE, ECHUCA VICTORIA 3564

CALL: +61 3 5482 5288

EMAIL: info@mrps.com.au

WEB: murrayriverpaddlesteamers.com.au

For reservations contact your travel agent:

Selected photos courtesy of Destination NSW