

MURRAY RIVER
PADDLESTEAMERS

— PS EMMYLOU —
Authentic Australian River Cruises



ECHUCA VICTORIA AUSTRALIA
SEASON 2022/23

Luxury Boutique Australian River Cruising

Optional Melbourne Hotel Stay Begins Your Journey

Optional Melbourne Return Transfers

Multi-Course Dining Prepared
By Our Onboard Chef

Complimentary Wine & Beer with Dinner

Riverside Dining & Campfires

Premium Onshore Guided Tours

Authentic Woodfired Paddlesteamer

Daily Historical Commentary

Complimentary Wifi Internet

Maximum 16 Guests Only

Book With
\$400
Per Person



Contents

PS EMMYLOU STORY	2
REGIONALLY INSPIRED DINING	3
MELBOURNE HOTEL PARTNERS	3
CABINS	4
2 NIGHT MURRAY RIVER ESCAPE CRUISE	5
3 NIGHT MURRAY RIVER DISCOVER CRUISE	6
4 NIGHT MURRAY RIVER EXPLORER CRUISE	7
6 NIGHT ALL THE RIVERS RUN CRUISE	8
2022-2023 CRUISE DEPARTURES	9
48 HOURS IN ECHUCA MOAMA	10
DRIVING TOURS	11
ECHUCA MOAMA SILO ART TRAIL	13
TERMS & CONDITIONS	15



Murray River & PS Emmylou Story

The side wheel paddlesteamers are distinctly Australian having first plied the Murray river in 1853, they established a thriving industry which survived until rail and roads began to service the region near the turn of the century. By 1873 there were 240 boats trading along the Murray River. The inland prospered as trade and commerce developed, and previously out of the way settlements were kept in touch with the cities.

With the introduction of the railway, the paddlesteamers and their industrious crews progressively lost work until the riverboat industry was but a shadow of it's illustrious past.

The Murray River which includes the Darling and Murrumbidgee rivers is one of the longest river systems in the world. Although weirs have cut down the navigability of the river, the Murray alone still claims 2508 kilometres of meandering waters.

PS Emmylou, the world's only wood-fired cruising paddlesteamer reminds us of the romantic days of the paddlesteamers and is now an Australian Icon of the River. Built locally during 1980-82 in the style of the 19th century paddlesteamers, she is perfectly at home at the Port of Echuca, residing with the last few remaining paddlesteamers of the past. She is 30 metres long and 10 metres wide, steel hulled and timber decked.

During 2018 PS Emmylou underwent a specially designed luxury upgrade and fit out. The new contemporary cabins and ensuites include fine linens topped with silky duvets, with the boats' premier cabin, the Emmylou Suite located on the front Upper Deck, with French Doors opening to a deck and 180 degree views of the river.

Guests can enjoy small boat boutique cruising at it's finest with just 16 guests comfortably accommodated in 8 deluxe cabins as PS Emmylou visits places of geographic, historic and Aboriginal cultural significance. Guests will also enjoy onshore tours visiting outstanding local wineries, dropping into local producers and accessing ancient world heritage Murray river tributaries aboard MV Kingfisher with an environmental specialist.

Onboard dining, prepared by the Emmylou's Chef, features local produce and wines from across the Heathcote and Perricoota wine regions. Riverside campfires are offered in the evenings, with stunning night skies to complete this unique experience.

We are proud to continue the tradition of overnight cruising on Australia's greatest waterway with our trademark level of country hospitality aboard an authentic paddlesteamer. We hope you can join us to connect you with Australia's inland history, geography, culture and cuisine.



OPTION
PRE/POST
HOTEL STAYS



WINE & BEER
WITH DINNER



ONSHORE TOURS



FREE INTERNET



DELICIOUS
REGIONAL CUISINE



COFFEE, TEA
& SNACKS

CONNECT WITH US



@MURRAYRIVERPADDLETEAMERS



@MURRAYRIVERPS



@MURRAYRIVERPS



MURRAYPADDLETEAMERS



Regionally Inspired Dining

Inspired by Australia's heartland, our menus take full advantage of our region's diverse bounty of fresh, local ingredients to fashion authentic dishes.

Your Chef takes great care in ensuring all guests dietary requirements are catered for whilst our onboard staff will charm you with traditional Australian country hospitality and attentive service.

A typical day cruising starts with an delightful range of continental choices, including fresh fruit, cereals and pastries or full English breakfast. Your Chef can also cook your favourite omelette or combination to order. Tea, coffee and a range of juices are always included with breakfast.

Lunches range from riverside picnics following onshore tours to extensive multi course dining featuring a choice of mains, salads, pastas, cold meats and desserts.

Dinner is the highlight of the day with a choice of regionally inspired main meals always offered. On 3, 4 & 6 night cruises you will experience our signature Riverside BBQ. Dining under the stars is a special experience as your chef and crew serve you a delicious classic Australian BBQ. After dinner relax at the riverside campfire with your fellow passengers toasting marshmallow.

Choose to sit with fellow passengers or with your partner, the choice is yours on all PS Emmylou cruises.

A wide variety of drinks is available including spirits, aperitifs and premium wines. On all cruises selected wines and beers are complimentary with dinner service. Complimentary Coffee, Premium Teas, Soft drinks and Bottled Water are available throughout your cruise.

DINING ABOARD EMMYLOU

- Tantalising multi course dinners
- Bountiful continental and full breakfast options
- Traditional morning and afternoon teas
- Vegetarian and gluten-free menu options
- Fabulous choice of local and Australian wines and beverages
- Complimentary selected wine & beer with Dinner service
- Free seat dining
- Seasonal alfresco dining with idyllic river views
- Riverside BBQ dining under the stars on all 3, 4 & 6 night cruises

Melbourne Hotel Partners

We are delighted to be partnering with the Pan Pacific Group with over 40 Hotels across Oceania, Asia & North America.



PAN PACIFIC SOUTH WHARF

Discover city of Melbourne along the Yarra River. Enjoy waterfront living at Pan Pacific Melbourne as you explore the South Wharf precinct with fabulous outlet shopping and bustling Melbourne just across the river.



PARKROYAL MELBOURNE AIRPORT

Why rush when your hotel is located so close to the airport. Arrive in style at Parkroyal Melbourne Airport. With direct access to international and domestic terminals you will enjoy convenience like no other.

\$80 per night surcharge applies for weekday stays at Parkroyal Hotel, Melbourne Airport.



Cabins

DELUXE CABINS WITH PRIVATE ENSUITES

Welcome to your home aboard Paddlesteamer Emmylou. We invite you to relax in a warm inviting atmosphere of mid 1800's riverboat charm without sacrificing modern conveniences. Emmylou features contemporary deluxe cabins with fine linens and plush new bedding which will ensure you are well rested to fully enjoy your time aboard with us. Complimentary Wifi is available throughout the boat.

MAIN DECK

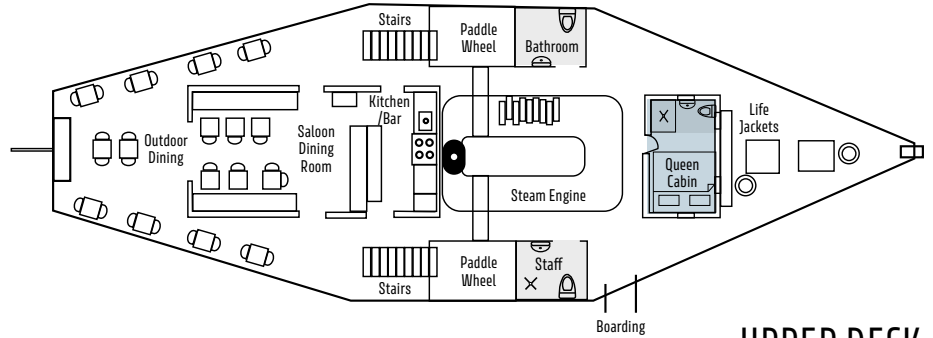

UPPER DECK

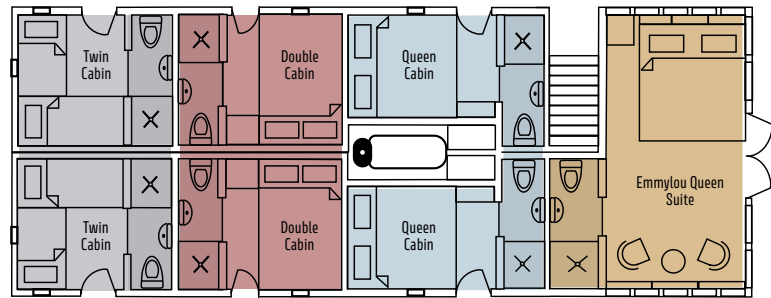

MAIN DECK CABIN

This private Queen Cabin boasts a plush queen bed and private ensuite. The cabin is conveniently situated on the Main Deck with close proximity to the dining Saloon.

UPPER DECK CABINS

Guests enjoying Upper Deck Cabins can choose from Queen, Double & Twin Single Cabins all with private ensuites, with doors opening to the outside affording neighbouring guests the unique opportunity to enjoy a social atmosphere, swapping stories and forming lasting friendships with fellow travellers.

EMMYLOU SUITE

PS Emmylou's premier and most spacious Cabin. This elegant suite provides a warm ambiance located on the Upper Deck at the front of the boat with French Door opening to the deck. Featuring a seating area, ensuite and plush queen bedding guests can relax with a drink and watch the river banks of the Upper Murray drift by.



Twin Cabin



Double Cabin



Queen Cabin



Emmylou Queen Suite

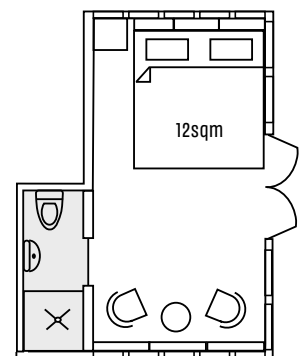
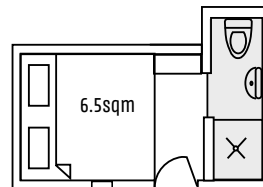
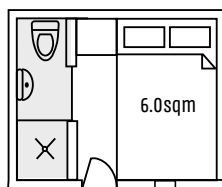
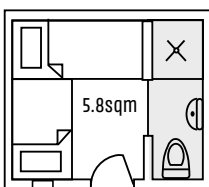

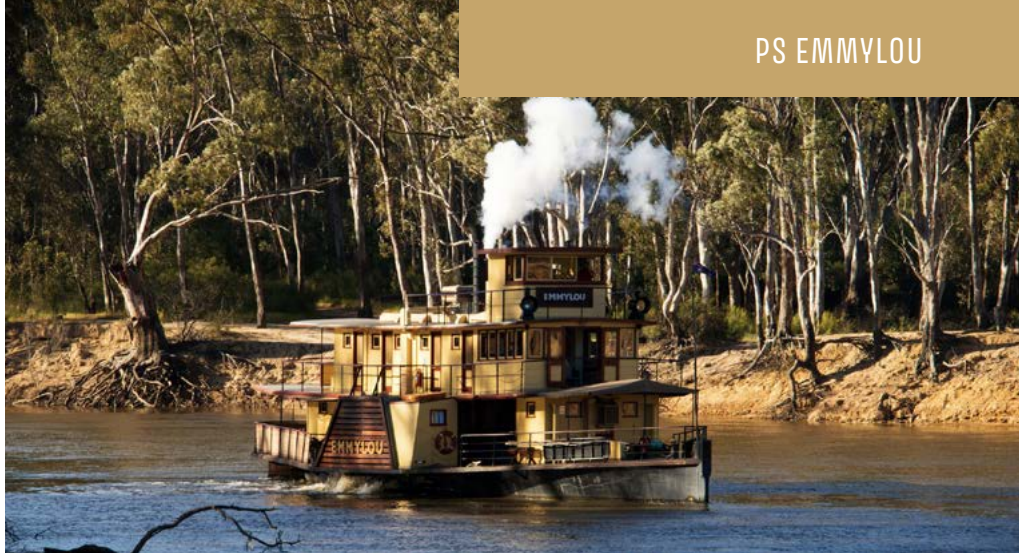

OPTIONAL EXTRAS

Melbourne Hotel Pre Stay & Return Transfers \$900 Per Couple
\$800 Solo Traveller

Melbourne Return Transfers \$650 Per Couple
\$550 Solo Traveller

Pre & Post Cruise Stay Echuca Mercure Hotel \$195 Per Night
Deluxe King Room

Self Drive Car Parking \$25 Per Night

THURSDAY/FRIDAY DEPARTURES



HIGHLIGHTS

- Guided walking tour of Perricoota Station
- After dinner riverside campfire
- See and hear native Australian wildlife
- All day river cruising with historical commentary

INCLUSIONS

- Regionally inspired chef prepared meals
- Selected wine & beer with dinner
- Coffee, tea, soft drinks and bottled water
- Complimentary Wifi throughout the boat

PRICES CRUISE ONLY

CABIN TYPE	PP TWIN SHARE	SOLO TRAVELER
Main Queen	\$1,080	NA
Upper Twin	\$1,040	\$1,664
Upper Double	\$1,040	NA
Upper Queen	\$1,080	NA
Queen Suite	\$1,300	NA

2 Night Murray River Escape Cruise

-Optional Ex Melbourne

Cruises depart Port of Echuca, Riverboat Dock, Echuca at 2.30 pm and return at 9.30 am. See Calendar for Departure Days.

DAY 1

Departing Echuca and steaming downriver, enjoy afternoon tea with freshly made scones served with jam & cream and your choice of tea or coffee. Immerse yourself in the sights and sounds of the river or take the opportunity to chat with the Engineer and Skipper in the wheelhouse about the rich history of the river and PS Emmylou. As the sun starts to set it's time for 'Happy Hour' in the saloon before sitting down to a welcome dinner. Listen to the river birds evening chorus, watch for kangaroos, wombats, egrets and many other species of birds as the stars begin to appear. Tonight, we moor at the famous Perricoota Station. Rich in history, the property was first settled by James Maiden in 1843, and famous for starring in the TV miniseries "All the River Run" where PS Emmylou was renamed PS Providence. Tonight is movie night with a special presentation of "Riverboats Remembered", a fabulous historical presentation featuring archival footage of the paddle steamers and communities of the Murray River from the early 1900's through to the mid 1970's.

DAY 2

Early rises and keen photographers are sure to see the morning mist rolling along the river. After breakfast join the Skipper for a walk past the buildings and vast gardens of Perricoota Station to the impressive homestead and learn about the rich history of the property which was once the area's largest sheep farm and fruit orchard. We then embark on a full day cruising the mighty Murray River towards Layfield Lane. You are welcome to join the Skipper in the Wheelhouse to learn how to steer Emmylou along the winding river. Later you can learn how the 1906 Steam Engine works with an informative chat from our Engineer, followed by a delicious lunch prepared by your chef. Tonight, it is time to dress up a little and enjoy a traditional 3 course dinner with all the trimmings complete with complimentary wines and beers. After dinner you are then welcome to join your fellow passengers around the roaring campfire to watch the stars appear in the stunning night sky before retiring for the evening.

DAY 3

Time for an early morning bush walk or relax over breakfast as we cruise back to Echuca arriving at 9.30am where we reluctantly say farewell.

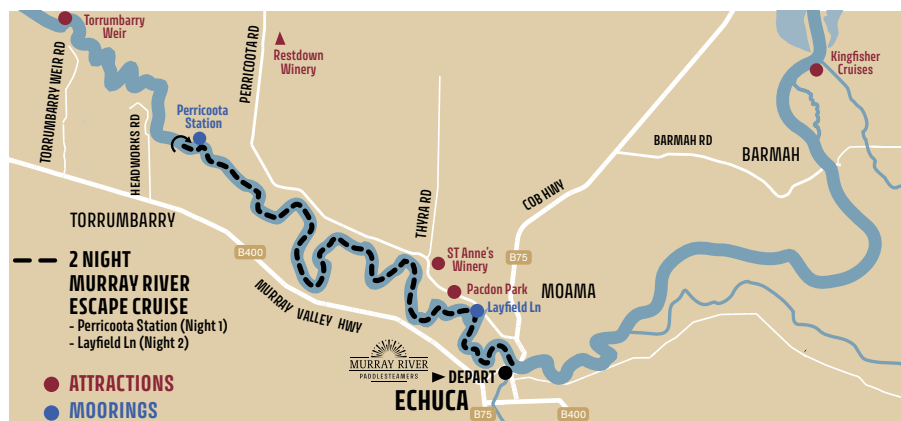

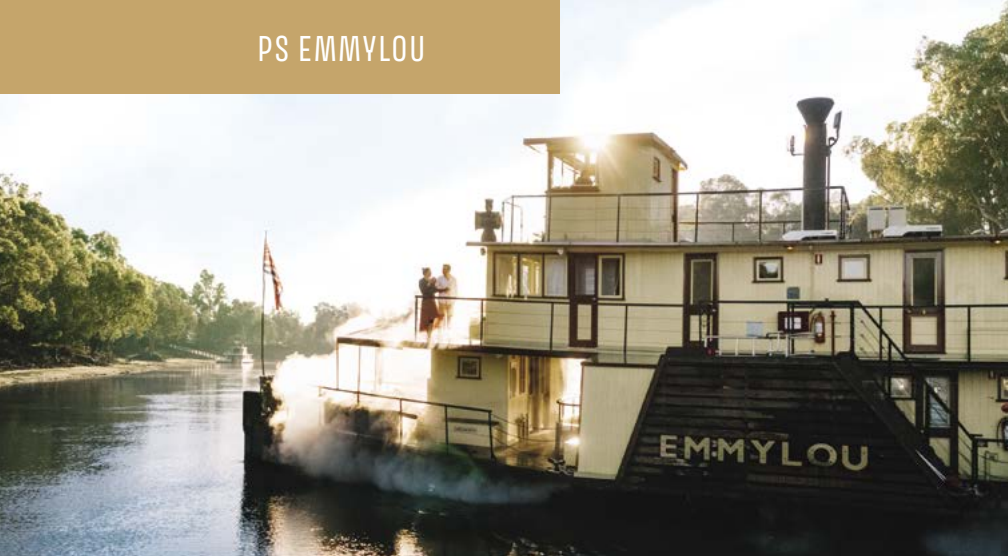

OPTIONAL EXTRAS

Melbourne Hotel Pre Stay & Return Transfers \$900 Per Couple \$800 Solo Traveller

Melbourne Return Transfers \$650 Per Couple \$550 Solo Traveller

Pre & Post Cruise Stay Echuca Mercure Hotel \$195 Per Night Deluxe King Room

Self Drive Car Parking \$25 Per Night

MONDAY DEPARTURES



HIGHLIGHTS

- Riverside grand dining under the stars
- Onshore tour – Eco boat tour & winery visit
- Visit Perricoota Station with garden tour
- After dinner riverside campfire

INCLUSIONS

- Regionally inspired chef prepared meals
- Selected wine & beer with dinner
- Coffee, tea, soft drinks and bottled water
- Complimentary Wifi throughout the boat

PRICES CRUISE ONLY

CABIN TYPE	PP TWIN SHARE	SOLO TRAVELER
Main Queen	\$1,710	NA
Upper Twin	\$1,650	\$2,640
Upper Double	\$1,650	NA
Upper Queen	\$1,710	NA
Queen Suite	\$2,040	NA

3 Night Murray River Discovery Cruise - Optional Ex Melbourne

Cruises depart Port of Echuca, Riverboat Dock, Echuca at 2.30 pm and return at 9.30 am. See Calendar for Departure Days.

DAY 1

Departing Echuca and steaming downriver, enjoy afternoon tea with freshly made scones served with jam & cream and your choice of tea or coffee. Relax and enjoy the sights and sounds of the river or take the opportunity to chat with the Engineer or with the Skipper in the wheelhouse about the rich history of the river and PS Emmylou. As the sun starts to set over the river it's time for an evening cocktail before sitting down to dinner. Listen to the river birds evening chorus, watch for kangaroos, wombats, egrets and many other species of birds as the stars begin to appear. Tonight, we moor at the famous Perricoota Station. Rich in history, the property was first settled by James Maiden in 1843, and famous for starring in the TV mini series "All the River Run" where PS Emmylou was renamed PS Providence.

DAY 2

This morning we depart on a half day excursion travelling to the small town of Barmah for a guided Eco Cruise, where you can get up close to Australian nature and wildlife gliding through the World-Heritage listed Barmah Wetlands aboard the MV Kingfisher. Enjoy a picnic lunch riverside before we continue to the region's largest winery, St Anne's where you will enjoy a

winery tour provided by the owners and taste their fabulous table and fortified wines. Arriving back at Perricoota Station join a guided walking tour of the buildings and vast gardens scattered with old date palms before PS Emmylou continues upriver towards Deep Creek Marina. Tonight, after dinner, it's movie night, with a special presentation of "Riverboats Remembered" a fabulous historical presentation featuring archival footage of the paddle steamers and communities of the Murray River from the early 1900's through to the mid 1970's.

DAY 3

This morning we depart on a full day of cruising towards our Layfield Lane Mooring. Enjoy the river views and wildlife as Emmylou steams her way upstream. Today you can learn how the 1906 steam engine works with an informative chat from our Engineer. Tonight, enjoy sampling the delicious range of Pacdon Park UK small goods for entrée before joining your fellow passengers at the riverside grand dining table for our signature Australian BBQ, star lit by the Southern Cross and candles followed by some yarns sitting around the campfire.

DAY 4

This morning before breakfast early risers can enjoy a riverside stroll before PS Emmylou then departs for the Port of Echuca where we reluctantly say farewell.

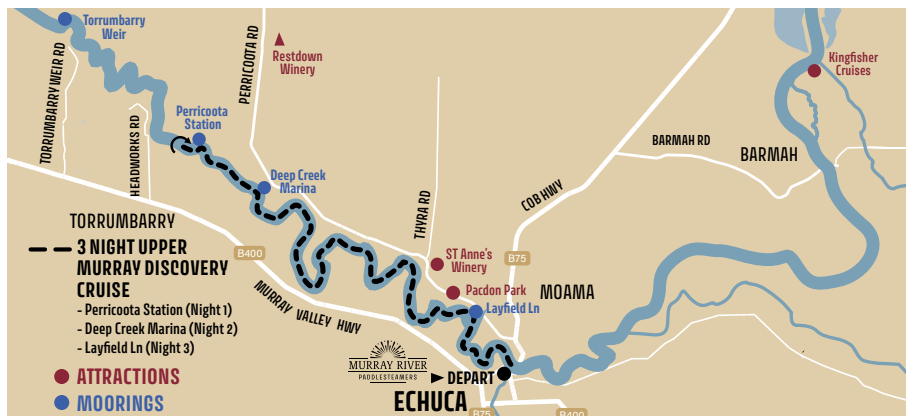



PS EMMYLOU

OPTIONAL EXTRAS

Melbourne Hotel Pre Stay & Return Transfers \$900 Per Couple
\$800 Solo Traveller

Melbourne Return Transfers \$650 Per Couple
\$550 Solo Traveller

Pre & Post Cruise Stay Echuca Mercure Hotel \$195 Per Night
Deluxe King Room

Self Drive Car Parking \$25 Per Night

MONDAY DEPARTURES



HIGHLIGHTS

- Riverside grand dining under the stars
- Two onshore tours – winery tour & lunch with owners
- World Heritage Wetlands eco boat cruise tour
- Visit Perricoota Station with gardens tour
- After dinner riverside campfire

INCLUSIONS

- Regionally inspired chef prepared meals
- Selected wine & beer with dinner
- Coffee, tea, soft drinks and bottled water
- Complimentary Wifi throughout the boat

PRICES CRUISE ONLY

CABIN TYPE	PP TWIN SHARE	SOLO TRAVELER
Main Queen	\$2,320	NA
Upper Twin	\$2,240	\$3,584
Upper Double	\$2,240	NA
Upper Queen	\$2,320	NA
Queen Suite	\$2,760	NA

4 Night Murray River Explorer Cruise - Optional Ex Melbourne

Cruises depart Port of Echuca, Riverboat Dock, Echuca at 2.30 pm and return at 9.30 am. See Calendar for Departure Days.

DAY 1

Departing Echuca and steaming downriver, enjoy afternoon tea with freshly made scones as you immerse yourself in the sights and sounds of the river. Take the opportunity to chat with the Engineer or the Skipper. As the sun starts to set it's time for 'Happy Hour' in the Saloon before a welcome dinner. Tonight we moor at the famous Perricoota Station. Rich in history, the property was first settled by James Maiden in 1843, and is famous for starring in the TV mini series "All the River Run" where PS Emmylou was renamed PS Providence.

DAY 2

Wake to your first morning on the river as you enjoy breakfast. Afterward it's off to Restdown Winery, producers of fine organic wines and Hereford beef. Join the property's owners for a guided tour along a 1.4km wetlands walking trail highlighting items of great Aboriginal significance. This is followed by a gourmet lunch of local produce with complimentary wine tastings. Returning to the Emmylou we continue downstream for Torrumbarry Weir. Here you can take a walk across the weir and visit the Interpretive Centre learning about the Murray Darling Basin, the weir and lock system which dates back to 1923.

DAY 3

This morning we steam upstream towards Perricoota Station where we depart to on a half

day excursion travelling 30 minutes to the small town of Barmah. Enjoy a traditional Australian picnic lunch riverside before departing on your guided Eco Cruise, gliding through the World-Heritage listed Barmah Wetlands aboard the MV Kingfisher. Upon your return join the Skipper for a walk past the gardens and buildings of Perricoota Station. We then continue cruising towards Deep Creek. Enjoy dinner as Emmylou steams into the night with her powerful lamps lighting up the banks of the river. After dinner enjoy a special presentation of "Riverboats Remembered", a fabulous historical presentation featuring the paddle steamers of the Murray River from the early 1900's through to the mid 1970's.

DAY 4

This morning we depart on a full day of cruising towards our Layfield Lane Mooring. Enjoy the river views and wildlife as Emmylou steams her way upstream. Today you can learn how the 1906 steam engine works with an informative chat from our Engineer. Tonight, enjoy sampling the delicious range of Pacdon Park UK small goods for entrée before joining your fellow passengers at the riverside grand dining table for our signature Australian BBQ, star lit by the Southern Cross and candles followed by some yarns sitting around the campfire.

DAY 5

This morning before breakfast early risers can enjoy a riverside stroll before PS Emmylou then departs for the Port of Echuca where we reluctantly say farewell.

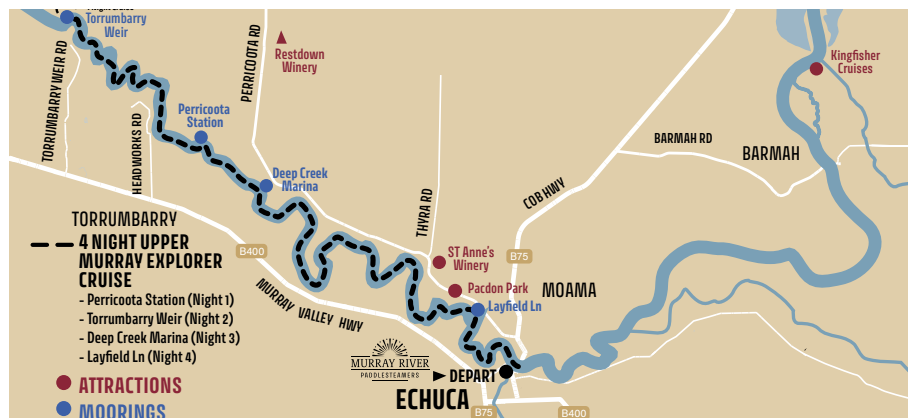



HIGHLIGHTS

- Relive the story of the series with movie nights
- Four onshore tours including a Echuca highlights tour
- Visit Swan Hill Pioneer Settlement with lunch
- Visit Lake Bogo Flying Boat Museum
- All day cruising & after dinner riverside campfires

INCLUSIONS

- Regionally inspired chef prepared meals
- Selected wine & beer with dinner service
- Coffee, tea, soft drinks and bottled water
- Complimentary Wifi throughout the boat

Cruises depart Port of Echuca, Riverboat Dock, Echuca at 2.30 pm and return at 9.30 am. See Calendar for Departure Days.

DAY 1

Departing Echuca and steaming downriver, enjoy a welcome afternoon tea with freshly baked scones served with jam & cream and your choice of tea or coffee. As the sun starts to set it's time for an evening cocktail before sitting down to dinner. Tonight, we moor at the famous Perricoota Station. Rich in history, the property was first settled by James Maiden in 1843, and is famous for starring in the TV mini-series "All the River Run" where PS Emmylou was renamed PS Providence.

DAY 2

This morning we depart on a half day excursion to the small town of Barmah. Here you board the MV Kingfisher for a guided Eco Cruise, where you can get up close to Australian nature and wildlife. Enjoy the timeless, natural beauty gliding through the World-Heritage listed Barmah Wetlands. This is followed by a riverside picnic lunch and a visit to St Anne's winery for a cellar door tour with the owners.

PRICES

CABIN TYPE	PP TWIN SHARE	SOLO TRAVELER
Main Queen	\$3,540	NA
Upper Twin	\$3,420	\$5,472
Upper Double	\$3,420	NA
Upper Queen	\$3,540	NA
Queen Suite	\$4,200	NA

6 Night All the Rivers Run Cruise

- Optional Ex Melbourne (See Optional Extras)

Arriving back at Perricoota Station join a guided walking tour of the buildings and vast gardens. This afternoon we cruise downstream towards Torrumbarry Weir.

DAY 3

This morning we depart on our day tour. You will visit Lake Bogo Flying Boat Museum and explore the famous Swan Hill Pioneer Settlement where lunch will be served. Upon your return to the Emmylou you can take a guided walk across the weir, visiting the Interpretive Centre and learning about the Murray Darling Basin and the weir and lock system which dates to 1923 before enjoying dinner overlooking the Weir. It is then time for movie night. With a special presentation of "Riverboats Remembered", a fabulous historical presentation featuring archival footage of the paddle steamers and communities of the Murray River from the early 1900's through to the mid 1970's.

DAY 4

This morning PS Emmylou departs cruising upstream towards Perricoota Station. We then depart for our onshore half day tour visiting Restdown Winery, producers of fine organic wines and Hereford beef. Here you can join the properties owners for a guided 1.4km wetlands walk along a trail highlighting items of great Aboriginal significance. This is followed by a gourmet lunch of local produce with complementary wine tastings. Upon arrival back at Perricoota Station we continue our journey upstream enjoying dinner

as we cruise towards our overnight mooring at Deep Creek Marina.

DAY 5

This morning PS Emmylou departs on a full day of cruising towards Layfield Lane, arriving late afternoon. Today you can learn how the 1906 steam engine works with an informative chat from our Engineer. Tonight, enjoy sampling the delicious range of Pacdon Park UK small goods for entrée before joining your fellow passengers at the riverside grand dining table for our signature Australian BBQ, star lit by the Southern Cross and candles. After dinner enjoy some yarns sitting around the campfire before retiring for the evening.

DAY 6

Enjoy breakfast on the deck then relax as we cruise towards the Port of Echuca. This afternoon you depart on a fully narrated tour of Echuca and its historic port, once the centre of Australia's thriving inland trade. You will visit historic sites and learn about the rich history of this beautiful riverside town. This afternoon and evening we cruise upstream from Echuca exploring the upper river enjoying dinner as the sun sets over the river before tying up for the evening at Morrisons Winery. Tonight, enjoy the final special presentation of All the Rivers Run.

DAY 7

This morning before breakfast early risers can enjoy a morning bush walk before PS Emmylou departs for the Port of Echuca where we reluctantly say farewell.

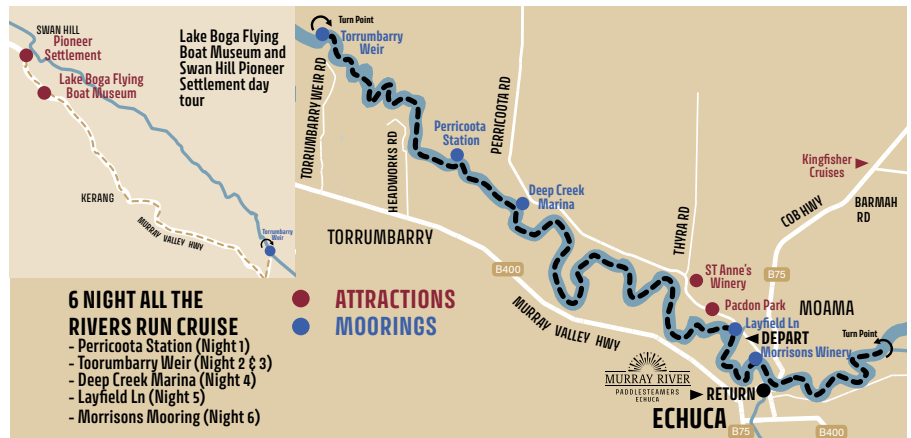

2022-2023 Cruise Departures

CRUISE DATES MAY BE SUBJECT TO CHANGE. SUBJECT TO AVAILABILITY

APRIL 2022

M	T	W	T	F	S	S
				1	2	3
4	5	6	7	8	9	10
11	12	13	14	15	16	17
18	19	20	21	22	23	24
25	26	27	28	29	30	

JULY 2022

M	T	W	T	F	S	S
				1	2	3
4	5	6	7	8	9	10
11	12	13	14	15	16	17
18	19	20	21	22	23	24
25	26	27	28	29	30	31

OCTOBER 2022

M	T	W	T	F	S	S
31					1	2
3	4	5	6	7	8	9
10	11	12	13	14	15	16
17	18	19	20	21	22	23
24	25	26	27	28	29	30

JANUARY 2023

M	T	W	T	F	S	S
30	31					1
2	3	4	5	6	7	8
9	10	11	12	13	14	15
16	17	18	19	20	21	22
23	24	25	26	27	28	29

APRIL 2023

M	T	W	T	F	S	S
					1	2
3	4	5	6	7	8	9
10	11	12	13	14	15	16
17	18	19	20	21	22	23
24	25	26	27	28	29	30

JULY 2023

M	T	W	T	F	S	S
31					1	2
3	4	5	6	7	8	9
10	11	12	13	14	15	16
17	18	19	20	21	22	23
24	25	26	27	28	29	30

OCTOBER 2023

M	T	W	T	F	S	S
30	31					1
2	3	4	5	6	7	8
9	10	11	12	13	14	15
16	17	18	19	20	21	22
23	24	25	26	27	28	29

MAY 2022

M	T	W	T	F	S	S
30	31					1
2	3	4	5	6	7	8
9	10	11	12	13	14	15
16	17	18	19	20	21	22
23	24	25	26	27	28	29

AUGUST 2022

M	T	W	T	F	S	S
1	2	3	4	5	6	7
8	9	10	11	12	13	14
15	16	17	18	19	20	21
22	23	24	25	26	27	28
29	30	31				

NOVEMBER 2022

M	T	W	T	F	S	S
	1	2	3	4	5	6
7	8	9	10	11	12	13
14	15	16	17	18	19	20
21	22	23	24	25	26	27
28	29	30				

FEBRUARY 2023

M	T	W	T	F	S	S
		1	2	3	4	5
6	7	8	9	10	11	12
13	14	15	16	17	18	19
20	21	22	23	24	25	26
27	28					

MAY 2023

M	T	W	T	F	S	S
1	2	3	4	5	6	7
8	9	10	11	12	13	14
15	16	17	18	19	20	21
22	23	24	25	26	27	28
29	30	31				

AUGUST 2023

M	T	W	T	F	S	S
	1	2	3	4	5	6
7	8	9	10	11	12	13
14	15	16	17	18	19	20
21	22	23	24	25	26	27
28	29	30	31			

NOVEMBER 2023

M	T	W	T	F	S	S
		1	2	3	4	5
6	7	8	9	10	11	12
13	14	15	16	17	18	19
20	21	22	23	24	25	26
27	28	29	30			

JUNE 2022

M	T	W	T	F	S	S
		1	2	3	4	5
6	7	8	9	10	11	12
13	14	15	16	17	18	19
20	21	22	23	24	25	26
27	28	29	30			

SEPTEMBER 2022

M	T	W	T	F	S	S
			1	2	3	4
5	6	7	8	9	10	11
12	13	14	15	16	17	18
19	20	21	22	23	24	25
26	27	28	29	30		

DECEMBER 2022

M	T	W	T	F	S	S
			1	2	3	4
5	6	7	8	9	10	11
12	13	14	15	16	17	18
19	20	21	22	23	24	25
26	27	28	29	30		

MARCH 2023

M	T	W	T	F	S	S
		1	2	3	4	5
6	7	8	9	10	11	12
13	14	15	16	17	18	19
20	21	22	23	24	25	26
27	28	29	30	31		

JUNE 2023

M	T	W	T	F	S	S
			1	2	3	4
5	6	7	8	9	10	11
12	13	14	15	16	17	18
19	20	21	22	23	24	25
26	27	28	29	30		

SEPTEMBER 2023

M	T	W	T	F	S	S
				1	2	3
4	5	6	7	8	9	10
11	12	13	14	15	16	17
18	19	20	21	22	23	24
25	26	27	28	29	30	

DECEMBER 2023

M	T	W	T	F	S	S
				1	2	3
4	5	6	7	8	9	10
11	12	13	14	15	16	17
18	19	20	21	22	23	24
25	26	27	28	29	30	31

 2 NIGHT MURRAY RIVER ESCAPE

 3 NIGHT MURRAY RIVER DISCOVERY

 4 NIGHT MURRAY RIVER EXPLORER

 6 NIGHT ALL THE RIVERS RUN



48 Hours in Echuca Moama

Arriving at the twin towns of Echuca Moama nestled on Australia's longest navigable river, replete with Mediterranean climate, you'll be able to boast about visiting two Australian states (NSW & Victoria) in one day. 48 hours in Echuca Moama provides a suggested highlights itinerary to make the most of your stay.

DAY 1

9AM BREAKFAST

Indulge in one of the many coffee spots around town – enjoy breakfast at one of the quaint sidewalk cafes

10AM MID MORNING

Step into the historic Port precinct, wander through the heritage streetscape, taking in the artists at work, the galleries, the winery, fudge shop, blacksmith at work & hop aboard the horse and carriage for a short ride around the town. Browse the displays telling stories of the river trade at the Port of Echuca Discovery Centre & the historic wharf.

11AM WHARF TO WINERY

Indulge in Australia's most unique restaurant aboard one of the Australia's historic Paddlesteamers, while cruising the river. Take the Wharf to Winery cruise, enjoying lunch at Morrisons Winery overlooking the vineyards & river.

2.30PM EARLY AFTERNOON

Having spent a leisurely few hours dining on or near the river, ramp it up with a visit to the strawberry farm (October – May) to pick your own strawberries and have a mid afternoon strawberry ice cream – breathe in the strawberry aroma while the luscious red berries are succulently warm and ready for tasting.

4PM LATE AFTERNOON

Call into the great Aussie Beer Shed on the way home to Echuca and marvel at the Australian collection and unlock the stories of many facets of Australian life. Back in town refresh at your accommodation and take a walk along the banks of the river through the stands of river red gums. Enjoy dusk with the setting sun as the birds fly in and sing their evening songs.

8PM DINNER

Dine at one of Echuca Moama's signature restaurants – the choice is yours! Local produce from the nearby farms and fruit and vegetable gardens are showcased on the menus. Tasting the local wines or craft beers you'll be spoilt for choice.

DAY 2

7AM EARLY MORNING

For those that like some early morning activity – jump on a stand-up paddleboard (SUP) and literally walk on water! Savour the stillness of the morning, with the light streaming through the river red gums with a pale pink sky and the fresh clear morning air – you'll never want to leave! For those who would prefer an early morning walk or jog, the river setting provides for a great meditative experience – one you won't forget.

9 AM BREAKFAST

To cool off, sit in one of the outdoor cafes or indulge in one of the many quaint little cafes around town! A smoothie, a caffeine heart starter or tingling fresh water is a great way to refresh after the early morning activity.

10AM MID MORNING

Wander the Historic Port Precinct and High Street Shops. Visit the Echuca Historical Society for a history lesson of the river and local communities.

12 NOON LUNCH

Feed your appetite with a lunch at one of our many eating spots – Mediterranean, Vegan, Pub or Asian are all there for you to try.

2PM EARLY AFTERNOON

A short drive to the township of Kyabram 30 minutes away you'll find a quaint little Australian town where there is still a glimmer of yesteryear. Shop, visit the Kyabram Town Hall with its quality art and fashion exhibitions, don't miss the Kyabram Fauna Park with its up close and personal Australian animal experiences and drop into the camel farm for an interesting encounter with the camels.

4PM LATE AFTERNOON

To complete the day pop into the, flour mill or local pub – they all provide an insight into the unique way of Australian life.

7PM EVENING

In winter book dinner at one of the many local pubs with a roaring fire. In summer become part of the local scene and enjoy some of the balmy evenings in the beer gardens, clubs, pubs or music venues.





SYDNEY TO MELBOURNE COAST & COUNTRY EXPLORER ROUTE – VIA ECHUCA

HIGHLIGHTS

- Join a local Aboriginal guide for an insightful look into the lives of the local Yuin people.
- See kangaroos playing in the waves at Peppy Beach.
- Explore incredible exhibits at MAMA – Murray Arts Museum Albury.
- Indulge the taste buds on a food fossicking tour in Bendigo.

DAY 1

Exchange urban views for the natural wonders of the coast as you begin the drive south to Melbourne via Echuca. The route takes you over the Sea Cliff Bridge which curves around the cliffs, floating 665 metres above the ocean waves. Arriving at Jervis Bay. Here, you'll find glorious white sandy beaches plus a mischievous pod of resident dolphins that play in the bay all year round.

DAY 2

Take your time as you head onwards today. Ulladulla is only a short drive from Jervis Bay but packed with art galleries and treasured curio shops. Seafood lovers should check out the Oyster Shed on Wray Street as you pass through Bateman's Bay. Meandering ever southwards Bermagui is a pretty, coastal village famed for the crystalline blue waters that surround it and the famous Blue Rock Pool. From this charming spot continue to Merimbula.

DAY 3

Today is a real road-trip. The route takes you deep into the legendary Snowy Mountains passing Lake Jindabyne and Mt Kosciuszko as you follow the Kosciuszko Alpine Way. Your destination is the twin cities of Albury Wodonga, straddling the Murray River.

DAY 4

Today you're heading for Echuca Moama. Named after the Aboriginal word for 'meeting of the waters', Echuca was once one of the busiest ports on the Murray River. Now, the twin towns of Echuca Moama are steeped in history. As you stroll along Murray Esplanade, where heritage buildings now house vibrant shops and cafes, the atmosphere of a bygone age is almost tangible. Time to board your PS Emmylou overnight cruise before ending your tour in Melbourne via Bendigo.

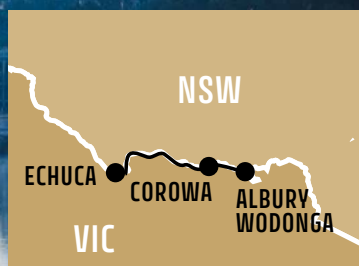

ALBURY TO ECHUCA – MURRAY RIVER ROUTE

HIGHLIGHTS

- Explore Murray Arts Museum Albury.
- Visit Corowa's Federation Museum & Whisky Factory
- Relax on Lake Mulwala or discover riverside walking tracks
- Indulge in the many gourmet food produced at Rich Glen Olive Estate.

DAY 1

Head for Corowa following the Riverina Highway west through countryside patchworked with emerald farmland. Arrive in Corowa and discover a town that played a big role in federation, leading the charge to unite Australia's six colonies. The fascinating story is detailed at the Corowa Federation Museum, which also houses a collection of historic Aboriginal artefacts. Sample more of the region at Corowa Whisky and Chocolate, occupying 1920s flour mills now a on-site distillery producing a fiery single malt, plus port, sherry and bourbon, alongside handmade chocolate blocks and bars.

DAY 2

Head to Yarrawonga-Mulwala. These twin cities occupying each bank of the Murray wraps up by

skirting man-made Lake Mulwala. This redgum-ringed reservoir boasts enormous populations of cod and crayfish. Explore walking trails, rent a kayak and soak up the serenity while bird-watching.

DAY 3

The journey from Mulwala to Tocumwal hugs the river, passing the Big Reedy Lagoon Wildlife Reserve (a twitcher's paradise) along the way. Visit the historic Aerodrome Museum, which tells the story of Tocumwal's significance during WWII. The day's final 110km journey to Echuca is where you can board PS Emmylou for your overnight cruise departing from the Port of Echuca, once the third-largest port in Australia, behind only Sydney and Melbourne.

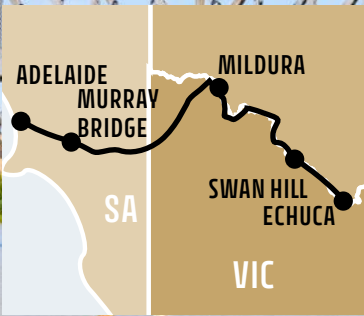

ADELAIDE TO ECHUCA – FOLLOW THE MURRAY ROUTE

HIGHLIGHTS

- Sip wine at quaint cellar doors in Victoria & South Australia
- Explore the largest open range Zoo in the world
- Cross in NSW from Mildura and explore NSW Perry Sandhills
- Step back in time with a visit to the Swan Hill Pioneer Settlement

DAY 1

Head from Adelaide to Murray Bridge where your Murray River drive adventure really begins. Along the way enjoy the heritage town of Hahndorf in the Adelaide Hills known for its cool-climate wines and Australia's oldest surviving German settlement. Stop by the Murray Bridge Regional Gallery where you'll find contemporary craft and artworks.

DAY 2

This morning visit the fabulous Monarto Safari Park, the largest open-range Zoo in the world. It is then time to check out Caudo Vineyard before heading to Renmark where you can relax and enjoy some outstanding food and wine from Banrock Station Wine and Wetland Centre.

DAY 3

It is time to cross the border driving 1.5 hours to Mildura in Victoria, a town of rugged nature and

quiet charm. Cross the border into NSW to visit the Perry Sandhills perfect for a picnic and then finish the day at Red Cliffs Lookout where you will find auburn cliffs carved by the Murray River.

DAY 4

Say goodbye to Mildura and set your sights on Swan Hill. It's about a 2.5 hour drive, but be sure to take your time as you weave alongside rivers and lakes. After you arrive in Swan Hill, explore the nearby Pioneer Settlement. Set on the banks of the Little Murray River, the Settlement tells the history of the Murray River with horse-drawn vehicles, blacksmiths, print shops.

DAY 5

A short drive to Echuca where you can board PS Emmylou and experience the Port of Echuca precinct. In the 1870s, this was the third-largest port in Australia, behind only Sydney and Melbourne.



ADELAIDE TO ECHUCA – INLAND GOURMET TRAIL

HIGHLIGHTS

- Visit world heritage Naracoote Caves and experience the underground world
- Savour the delights of the premier Coonawarra wine district
- Explore the Southern Grampians and dine at the renowned Royal Mail Hotel
- Delve into Australia Gold Rush history visiting Sovereign Hill, Ballarat
- Uncover Bendigo's fabulous Art and Food culture

DAY 1

This morning rise early for the drive to Naracoote in the limestone region of South Australia. Visit the Australian Fossil Mammal site, then visit the natural wonders of the Naracoote Caves National Park with guided tours in the Alexandra and Victoria caves.

DAY 2

Today visit the Coonawarra wine region, world-renowned for its Cabernet Sauvignon. See why it's called the Bordeaux of Australia, with 30 winery cellar doors. Visit historic Wynns Coonawarra Estate featuring the famous triple-gable roof and stone buildings, and Rymill Coonawarra with its full-sized bronze dancing horses, art and viewing gallery.

DAY 3

Today we cross the border into Victoria visiting the beautiful city of Hamilton and the Hamilton Galley, before arriving in the Southern Grampians at Dunkeld. Visit the famous Royal Mail Hotel where

the mountains provide a stunning backdrop for a fine dining experience and overnight stay.

DAY 4

Set your sights on Gold Country with a visit to Ballarat and Sovereign Hill, a recreated gold rush town and outdoor museum. Explore tunnels, shops, streetscapes and pan for real gold. If staying longer book an overnights stay at Craig's Royal Hotel. It's then time to visit Bendigo, the original gold rush boom town and home to the Centre Deborah Gold Mine. Explore its vibrant arts hub and world-class food and wine scene, set against rich gold-rush history, grand architecture and magnificent gardens.

DAY 5

A short drive to Echuca where you can board PS Emmylou and experience the Port of Echuca precinct. In the 1870s, this was the third-largest port in Australia, behind only Sydney and Melbourne.

ECHUCA MOAMA

Silo Art Trail

SMALL TOWNS & SURROUNDS

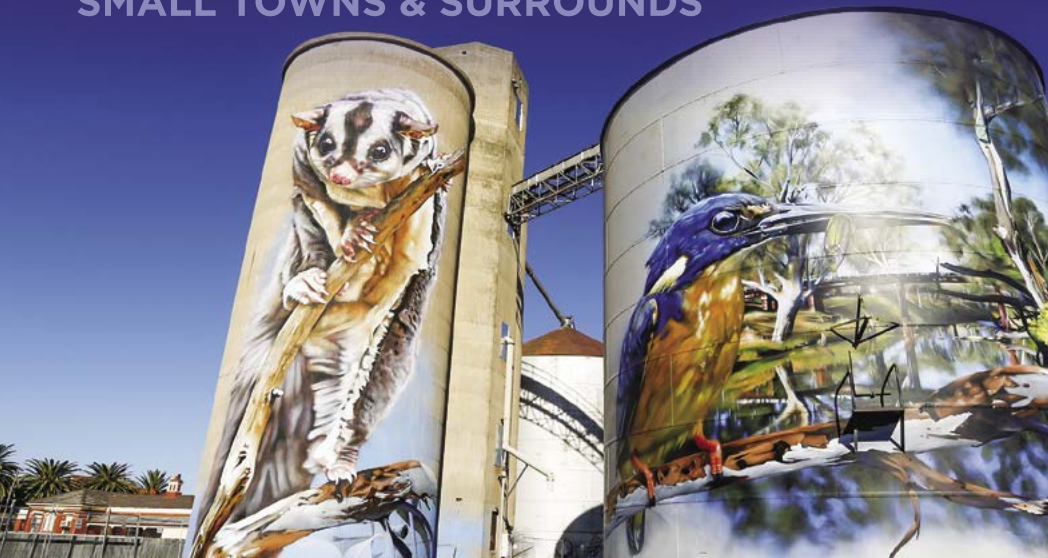

It's big, it's bold, it's beautiful, and it's no wonder that the popularity of silo art has boomed across Australia over the past six years.

The Echuca Moama region and surrounds is home to three spectacular art silos and one art water tank. Follow the map in this brochure and explore our other art and cultural attractions along the way.

ROCHESTER

The Rochester GrainCorp Silos were the first silos painted in the Echuca Moama region and are the work of artist, Jimmy Dvate. Completed in 2018, the silos feature two threatened local species, the azure king fisher and the wrist-winged squirrel glider.

18 Ramsay St, Rochester

Nearby:

- **Iddles Lane:** Former Victoria Police homicide detective, Ron Iddles, has been commemorated in his hometown of Rochester. The Iddles Lane mural was painted by Tim Bowtell and celebrates the achievements of one of the state's most respected detectives.
- **Mural Park:** Located off Moore Street in Rochester, Mural Park features a selection of 2.1m x 4.8m murals created as part of the annual Rochester Mural Festival. New murals are added each year.

- **Rochester Sports Museum:** View more than 4,000 exhibits showcasing Australia's sporting history, including Adam Gilchrist's wicket-keeping gloves, one of Greg Norman's iconic hats, and a tennis dress worn by Martina Navratilova.

COLBINABBIN

The six-silo art mural in Colbinabbin was painted by Tim Bowtell in 2020, and depicts significant moments from the town's history, including its important links to agriculture, community, environment and the construction of the railway. Collins St, Colbinabbin

KYABRAM WATER TANK

The Kyabram water tank, owned by Goulburn Valley Water, is the most recent addition to the Echuca Moama region's silo art. Painted by Jimmy Dvate in March 2021, it features the Kyabram Fauna Park wetlands and some of the wildlife that inhabit them, including the eastern long neck turtle, golden whistler, red-capped robin, yellow crimson rosella, Major-Mitchell's cockatoo, endangered plains-wanderer, spotted-tail quoll, blue skimmer dragonfly, brolga and a bush tone-curlew. Cnr Drum & Union St, Kyabram

Nearby:

- **Kyabram Town Hall Gallery:** Housed in the historic town hall building, the gallery is one of the largest in the region and showcases regional artists, touring exhibitions and a changing exhibition program of vintage clothing.
- **Tongala:** Visit Tongala and marvel at the 40+ street murals painted on buildings and fences around the town centre. The Hay Bale Trail also pops up at Christmas and Easter, with local artists and farmers coming together to add even more colour to this artistic town. 15 mins drive from Kyabram.

- **Stanhope:** Visit dedicated country music venue, the Neon Horse; the Many Makers Gallery; Shaque-a-Taque with its miniature villages and handcrafted gifts; and the Fonterra Mural, which features thousands of individual photos that create one enchanting artwork. 15 mins drive from Kyabram
- **Girgarre Sound Walk:** A hands-on musical journey through town, using repurposed materials to create interactive musical instruments. 15 mins drive from Kyabram, 8 mins drive from Stanhope.

PICOLA

Around 45 minutes drive from Echuca Moama is the Picola art silo, which was painted by Jimmy Dvate in 2020. It features the culturally significant Barmah National Park and some of the wildlife that calls it home. The silos are still operational and located on private land, however can be viewed from the roadside. 25 Moran St, Picola

ECHUCA MOAMA

While staying in Echuca Moama, be sure to visit some of the local art experiences on offer.

- **Galleries:** Customs House Gallery, Foundry Arts Space, Whistlestop Gallery; Port Atelier & Alton Gallery
- **Museums:** Port of Echuca Discovery Centre, Echuca Historical Society Museum, National Holden Museum, Chanter Estate Military Museum, and The Great Aussie Beer Shed and Heritage Farm Museum
- **Outdoor art:** David Maughan's Les Belle Helen II sculpture in the Moama Botanic Gardens, Geoff Hocking's Long Paddock sculptures near the Moama Soundshell and Timber Cutters sculptures at Edward River Bridge picnic area, Corey Thomas's Long Paddock sculptures at the Mathoura Visitor Information Centre, and Jimmy Dvate's mural on the side wall of the Gunbower Hotel.

Trail map



Visit echucamoama.com to see more art experiences from around the region and the Campaspe Arts Trail map.

Suggested Route

*MAP NOT TO SCALE

Echuca Moama
The Murray's living legend

To get firsthand local information and to book your Echuca Moama experience visit the **Echuca Moama Visitor Centre**. Free call **1800 804 446**, visit the website www.echucamoama.com or find us right on the river, just before the bridge at 2 Heygarth Street, Echuca.



Terms & Conditions

General

The transportation of guests and baggage aboard the vessel/s is governed by these Terms and Conditions. Please carefully read the terms of this cruise agreement.

Your payment of deposit or full fare constitutes agreement to these terms and conditions which includes limitations and exonerations of the liabilities and obligations of Carrier. You should read and understand these terms and conditions carefully before making a deposit. The vessel/s is operated by Australian Paddlesteamers Pty Ltd, trading as Murray River Paddlesteamers (MRPS) and is regularly inspected by the Australian Maritime Safety Authority, AMSA.

Definitions

The terms "you" and "Guests" refer to any and all person(s) named on the front of the Confirmation and include all children or others under the care or control of the named person(s). The term "Carrier" includes Murray River Paddlesteamers, its parent and affiliated entities, the vessels, the owners, charterers, operators, agents, and masters and crews thereof, any substituted or connecting ship, the owners, charterers and operators and all launches belonging to any such boat or owned or operated by the owners, charterers or operators. The term "Fare" includes voyage and shore excursions purchased from Carrier.

Fares are in Australian Dollars, are per guest, are based on double occupancy, and do not include air or land transport.

Single Occupancy Fares carry a 60% surcharge. Port charges are included in the fare. All fares, itineraries, themes, entertainment, shore excursions and other voyage attributes are subject to change without notice and we reserve the right to not honour any published prices that we determine were erroneous due to printing, electronic or clerical error.

Deposit and Final Payment

For confirmation of individual bookings, a non refundable deposit of \$400 of the full fare per person is due upon booking online & within 3 days if booking direct or via a travel agent. The balance of the voyage fare is due ninety days (90) prior to departure date, and all reservations not fully paid at such time will be cancelled and subject to the cancellation provisions set forth in the cancellation policy below. MRPS accepts the following forms of payment: MasterCard, Visa & Bank Transfer. A credit card surcharge between 1.20% - 1.70% maybe incurred for credit card payments depending on the credit card used. Domestic Australian Bank Transfers incur no surcharge or cost. International Bank Transfers incur a minimum A\$15 fee which must be added to the payment made. Bookings made ninety (90) days or less prior to the departure date require payment in full at the time of booking.

Cancellation and Change Policy

Guests who must cancel or change the date of their voyage or any part of their package for any reason, including medical or family reasons, are subject to the fees as outlined below. All fares are based on double occupancy; on reservations in which one guest cancels, the remaining guest is responsible for paying any and all single supplements. MRPS reserves the right to cancel all reservations for which final payment is not received ninety (90) days prior to the departure date.

You acknowledge that your cancellation will cause MRPS difficulty in selling a replacement cruise and thus the cancellation fees herein apply regardless of whether your cruise is resold. You agree that any losses sustained by MRPS in the event of cancellation would be very difficult or impossible to quantify and the cancellation fees are fair and reasonable as liquidated damages. The following cancellation fees will be assessed for all written cancellations received prior to departure up to the scheduled time of departure.

Days Prior to Departure

Up to 91 days	Loss of Deposit
90-31 days	50% of gross fare
30-0 days	100% of gross fare

MRPS recommends that all guests obtain travel insurance for unforeseen circumstances.

Included in your fare

- Bottled water/softdrink
- All meals • Coffee & Tea
- Selected Wine & Beer with dinner (from 1st April 2021)
- All standard shore excursions
- Wi-Fi Internet access aboard the vessel
- Gratuities to vessel crew

Not included in your fare

- Airfare to and from your home city
- Alcoholic beverages not stated
- Travel Insurance
- Transfers to and from Melbourne

Payment for additional goods and services must be made prior to the guest's disembarkation. Card only payment. No cash is accepted.

Documentation

Final travel reminder, including itinerary and passenger cruise information guide will be sent two (2) weeks prior to departure. Itineraries are subject to change without notice.

Health & Disability Requirements

Guests must notify MRPS in writing at the time of booking of any physical or mental illness, disability or other conditions for which special accommodations or the use of a wheelchair is necessary or contemplated. Also, we must be notified of any medical treatment that may render the guest unfit for travel or constitute a risk or danger to the guest or anyone else aboard. The vessel does not carry a medical doctor aboard. Acute medical conditions will require you to disembark to be attended to by shore-side emergency and/or medical response. Guests needing any form of assistance and those who are physically disabled must be accompanied by someone who will take full responsibility for any needed assistance during the cruise and in the event of an emergency. We reserve the right to refuse passage to anyone who, in our sole opinion, may affect the health, safety or enjoyment of other guests. Guests requiring a wheelchair must provide their own collapsible wheelchair. Please be aware that some ports of call, shore excursions, docks, gangways and other requirements may preclude a wheelchair guest from leaving the vessel; this decision will be made by the ship's captain and is binding. Also, there may be certain physical conditions, including stairways and narrow passageways within the vessel that may limit or preclude the accessibility of wheelchair guests to some areas. We strongly recommend you purchase travel insurance. With travel insurance, you can plan and enjoy your trip with complete peace of mind.

COVID-19 Health

If at any time a cruise cannot operate due to government-imposed sailing restrictions guests will be offered a future cruise credit for 100% of any funds paid, valid for 18 months of the original departure date. Refunds will not be offered and any extension beyond 18 months will be at Managements discretion. Passengers must complete the Pre-Cruise Health Questionnaire at check-in and comply with management directions, including having their temperature taken before and during the cruise. Guests must comply with the Captains instructions regarding all COVID-19 hygiene and social distancing requirements.

Smoking

Smoking is not permitted anywhere aboard the vessel including inside cabins and suites.

Dining Arrangements

MRPS offer open-seating for breakfast, lunch and dinner. To make a seating request with other guests aboard please contact us.

Gambling

Gambling is not permitted on the Vessel/s.

Animals

Only designated service animals are permitted aboard. You are required to notify MRPS in advance of departure if you plan to bring along a service animal because of a disability. Supporting documents may be requested.

Carrier's Discretion

As the Carrier, we reserve the right at any time, without notice, to cancel any cruise or Cruise Tour, to change or postpone the date or time of sailing or arrival, to change the port of embarkation or final destination, to shorten the cruise or to change or substitute any component of the Cruise Tour. If we are required to do any of these things, we will be responsible to you as follows:

If we cancel the cruise or Cruise Tour before it has started, we will refund the Cruise Fare that we have actually received. If the scheduled sailing date or time is delayed and as a result of that delay, you are not otherwise accommodated on board the Ship, we may arrange hotel accommodations and food at no additional expense to you for the duration of the delay. If the cruise is shortened, we will make a proportionate refund of the Cruise Fare. MRP responsibility does not extend beyond the vessel, and whenever passengers leave it, any arrangements made by them or for them are at their own risk.

Limitation on Carrier's Liability

- (a) No liability for certain events. The Carrier and the vessel/s shall not be liable for loss, death, or delay of, or injury to, any passenger or loss or damage or delay to his/her baggage, personal effects or other property, arising from: acts of God, public enemy, government restraint, riots, strikes, lockouts, labour troubles, whoever may be the instigators thereof, epidemic, civil disturbances of whatever nature, perils of the rivers, or other navigable waters, fuel shortages, collision, stranding, fire, theft, barratry, or any other crime by any person, faults or errors of navigation or management of this or any other vessel, explosions, breakage of shafts or any defect or unseaworthiness in hull, machinery or appurtenances, equipment, furnishings or supplies of the vessel or launches or vehicles or any defect of the Carrier's premises, at whatever time existing, fault or neglect of pilots, tugs, regular members of the crew, agents, servants, independent contractors.
- (b) Limitation on Carrier's liability with respect to baggage and personal property. This liability shall not exceed one hundred Australian Dollars in the event of loss, damage or delay to any of the passenger's baggage or other property taken with him/her on the voyage.

Guest Warranties.

You warrant that you and all other Guests traveling with you are physically, emotionally and otherwise fit to undertake the cruise or Cruise Tour; that you and they have received all medical inoculations necessary; that you and they will at all times comply with the Ship's rules and regulations and orders and directions of the Ship's Captain and officers, and that your conduct will not impair the safety of the Ship or jeopardize or inconvenience other Guests. We may disembark at any time any Guest who may be suffering from contagious or infectious diseases or whose presence, in the opinion of the Captain, may be detrimental to the comfort or safety of other Guests or the crew. In such cases, the Guest shall not be entitled to any refund of the cruise fare or Cruise Tour fare or any compensation whatsoever.

Alcohol Policy

The sale and consumption of alcoholic beverages will be limited to Guests who are 18 years or older. MRPS promotes the responsible service of alcohol and will refuse service to guests if deemed to be intoxicated. Guests are kindly reminded to consume alcohol in moderation. MRPS reserves the right to prohibit and retain all liquor brought onto vessels which is strictly prohibited.

Use of Likeness

Carrier has the exclusive right to use video and other visual/ audio portrayals of you or your likeness taken during your cruise in any medium of any nature whatsoever for any purpose, including advertising or promoting the services of Carrier without any compensation being paid to You. Any such portrayal or likeness shall be the exclusive property of the Carrier.

Children

Due to the nature of the cruise and travel itineraries, the Carrier does not maintain facilities or services on its vessels for individuals under the age of 18 years. You must be 18 years old on or before the day you are scheduled to embark on the cruise tour.

Non-Transferrable Tickets

- (a) Your authority to agree. In buying the passenger ticket you state that you are authorised by or on behalf of any passenger listed on the ticket (including any minor) to agree to all the terms and conditions of this agreement.
- (b) No transfer. This agreement is between the Carrier and the passenger. It cannot be sold, assigned or transferred to any other person without prior express written consent of the Carrier.

Australian Consumer Law

Nothing in these Terms and Conditions operates to exclude, restrict or modify any provisions of the Competition and Consumer Act 2010 (Cth) or any equivalent laws applicable in any State or Territory in Australia.

Terms and conditions are subject to change without notice and we are not responsible for errors or omissions therein.



MURRAY RIVER

PADDLESTEAMERS
Authentic Australian River Cruises

MURRAY RIVER PADDLESTEAMERS
57 MURRAY ESPLANADE, ECHUCA VICTORIA 3564
CALL: +61 3 5482 5244
EMAIL: info@mrps.com.au
WEB: psemmyloucruises.com

For reservations contact your travel agent: